



Floors guide

Composite floor solutions



Contents

| | |
|--------------------|---|
| Introduction | 3 |
|--------------------|---|

Composite floors decking

| | |
|---------------------|---------|
| Cofrastra® 40 | 4 & 5 |
| Cofraplus® 45 | 6 & 7 |
| Cofrastra® 56 | 8 & 9 |
| Cofraplus® 60 | 10 & 11 |
| Cofraplus® 80 | 12 & 13 |

Long span floor decking

| | |
|-------------------------------------|----|
| Cofraplus® 220 | 16 |
| Installation - Cofraplus® 220 | 19 |

Integrated floor systems

| | |
|--|---------|
| Cofradal® 200 & 260 | 20 & 21 |
| Installation - Cofradal® 200 & 260 | 22 |

Installation

| | |
|-------------------------------|----|
| Composite floor decking | 25 |
| Reinforcement | 33 |

General instructions

| | |
|--------------------|----|
| Safety | 34 |
| Installation | 35 |



<https://construction.arcelormittal.com/cofra5/>

Cofra® 5

Our free software, Cofra® 5 is the ideal tool to design your project using one of our composite floors. By entering the hypothesis of your specific project (spans, loads, fire resistance...), Cofra® 5 provides a full calculation note with the steel thickness of our floor system, the slab thickness and the section and position of reinforcements necessary to reach your own specifications.

The design fits with Eurocodes requirements.

Our technical assistance teams are also there to help you and to counsel you towards the best technical solution for your project.

Composite flooring solutions

Our extensive range of floor systems allows our customers to find the right fit to suit their project needs.

ArcelorMittal Construction's composite flooring continues to lead the way

Our wide range of floor system is a lightweight alternative to any other concrete solution. Not only does this make them quicker and easier to install, transport and store, they're more cost effective because less substantial supporting structures are required. Plus, less equipment is needed to move and position our systems.

Meanwhile, all of the solutions within our composite flooring range can be installed with all types of structures, such as steel, concrete, wood beams and masonry walls.

They all come galvanised with our metallic coating, ZMevolution® as standard to increase durability, and can be pre-painted with our own brand of organic coatings to enhance aesthetics and protection against corrosion.

Multi-application from new building to renovation

As a result, they can be used for the widest range of projects, including commercial and office buildings, high-rise buildings, and educational, car parks, sports facilities, and more. As they are lightweight flooring solution, stackable and easy to manually install, they are naturally adapted for renovation projects.

Our flooring solutions

Composite floors:

They are multi-use solutions:

- during pouring phase, they are used as shuttering
- when the concrete is dried, thanks to the embossments and the geometry of the profile, a mechanical bond is formed between steel and concrete. In that respect, steel fully contributing to the slab resistance creating a composite slab
- in fire condition, they can reach REI120 by adding rebars in the ribs

Integrated floor systems: In that unique system, the insulation is directly included into our flooring solution providing thermal insulation.

The optimal combination of the materials used for these floor system enables them to bridge spans from 5 to 8 m providing at the same time an excellent sound absorption and fire resistance.

Additive floors: The additive floors concept takes advantages of both materials, steel and concrete, providing an optimised solution for long span as it can reach spans up to 5.50 m without props and 9 m with props.

They are also suitable for building where fire resistance up to 120 min is required.

Slim-Floor concept: With this concept, the top of the profile is at the same height that the beam which supported it or directly installed on the lower flange. It allows to reduce the total height of the structure and eliminating beam downstands under the floor.

Our additive floors and integrated floor system fit perfectly with this concept which guarantees a fast installation, an economical design and open new doors to architect's imagination.

Composite beams: Our floors can be connected to the beams using some studs creating a composite beam. This allows to optimize the design of the beam and thus the global weight and cost of the building.

Some key terms...

g': permanent loads in the final phase (excluding the self-weight of the floors).

q: live loads in the final phase.

L span: means the distance between supports (can be calculated as clear distance between supports in the case of a concrete structure). If propping is necessary, the span differs between the pouring phase and the final composite slab.

SLS: Service Limit States - states describing the service criteria of a floor system (deflection, cracking, vibration, etc.)

Deflection: maximum deformation of the floor under a combination of SLS loads. Limited to $L/180$ in the pouring phase.

REI: resistance of the floor to fire for mechanical stability (R), flame proofing and tightness (E) and thermal insulation (I).

Cofrastra® 40

Composite floors decking with dovetail section

Featuring a re-entrant section, Cofrastra® 40 is suitable for slim and lightweight floor construction. With a classical pitch of 150 mm, it's the lowest composite floor decking around, yet offers optimum adhesion between profile and concrete which enables it to support heavy loads.

The Cofrafix clip system allows to suspend building equipment, ducts or false ceilings... without any dowels, pins or drilling.



Fire resistant



Thin slab

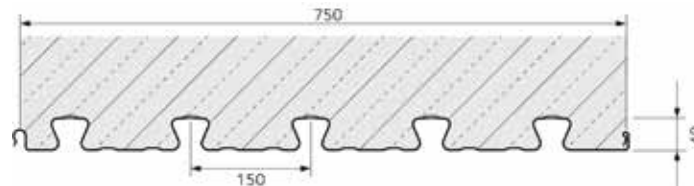

CE marking according to EN 1090-1
German technical approval: AbZ Z-26.1-22

| Characteristics of the base material | | Norms |
|--------------------------------------|-------------------------|---|
| Steel grade | S 350 GD | EN 10346 |
| Corrosion protection | Galvanised steel ZM 175 | P 34-310 ETPM ZMevoolution® or AbZ Z-30.11-61 |

| Characteristics | Nominal thickness of the profile sheet [mm] | | |
|--|---|-------|-------|
| | 0,75 | 0,88 | 1,00 |
| Weight [kg / m ²] | 9,80 | 11,50 | 13,10 |
| Cross section A _c [mm ² / m] | 1 183 | 1 400 | 1 600 |
| Effective inertia I _{eff} [cm ⁴ / m] | 17,58 | 22,23 | 25,41 |
| Height of neutral axis [mm] | 10,60 | 10,60 | 10,60 |
| Modulus of inertia [cm ³ / m] | 16,57 | 20,95 | 23,95 |

Nominal concrete consumption

| | Thickness of the slab [cm] | | | | | | | | | |
|--|----------------------------|-----|-----|-----|-----|-----|-----|-----|-----|-----|
| | 9 | 10 | 11 | 12 | 13 | 14 | 15 | 16 | 17 | 18 |
| Concrete volume [l / m ²] | 80 | 90 | 100 | 110 | 120 | 130 | 140 | 150 | 160 | 170 |
| Theoretical weight* of the composite slab [kg / m ²] | 200 | 225 | 250 | 275 | 300 | 325 | 350 | 375 | 400 | 425 |

Concrete density 2500 kg / m³

Maximum recommended slab thickness d = 20 cm

*Additional weight du to pounding effect is not included

Cofrastra® 40P:

Pre-punched version, compatible with shear connectors, welded in advance or in shop to the composite beams.



Fire resistance

| | REI [min] | | | |
|----------------------------|-----------|----|----|-----|
| | 30 | 60 | 90 | 120 |
| Thickness of the slab [cm] | 9 | 9 | 11 | 13 |

REI: fire protection rating of the raw composite slab

The minimum thickness is required to comply with the temperature criterion (I) on the non- fire exposed side.

According to EN 1994-1-2 §4.3.2, Cofrastra® 40 composite floors are by default REI 30.

For higher fire resistance classes, reinforcement bars are required. These are positioned in the ribs of the profile.

Their section is determined by using Cofra® 5.

Sound insulation

The acoustic behaviour of a raw composite slab is determined by its mass.

Given values are calculated by modelling – study report CœSTB No. AC15-26054708

| | Thickness of the slab [cm] | | | | | | | | | |
|---------------------|----------------------------|----------|----------|----------|----------|----------|----------|----------|----------|----------|
| | 9 | 10 | 11 | 12 | 13 | 14 | 15 | 16 | 17 | 18 |
| R _w [dB] | 46 | 47 | 48 | 49 | 50 | 50 | 51 | 52 | 52 | 53 |
| (C; Ctr) [dB] | (-1; -6) | (-2; -6) | (-2; -6) | (-2; -6) | (-1; -6) | (-1; -6) | (-1; -6) | (-2; -7) | (-1; -6) | (-2; -7) |

Acoustic performance of the Cofrastra® 40 Décibel floor system

| | Complex | R _w (C; Ctr) | L _{n,w} | CSTB Report |
|--|---------|-------------------------|------------------|-------------|
| Cofrastra® Décibel: Cofrastra® 40 + slab thickness 140 mm + plenum space 70 mm + plasterboard BA13 | | 56 (-6; -11) dB | 66 dB | 23268 |
| Cofrastra® Décibel: Cofrastra® 40 + slab thickness 140 mm + plenum space 70 mm + IBR 60 mm + plasterboard BA13 | | 65 (-4; -10) dB | 61 dB | 23268 |

Structural performance

Load / Span table

The value provided in each cell of the table loads is the maximum live load capacity Q (kN / m²). The self weight of the slab is already included. The color of each cell give information about the required steel thickness.

A calculation using Cofra 5 optimises these values according to the project requirements.

Single span 

| Thickness of the slab [cm] | Span [m] | | | | | | | | | | | | | | | | | | | | | |
|----------------------------|------------------|---------------|-------|-------|-------|-------|-------|-------|-------|-------|-------|-------|-------|-------|-------|-------|-------|-------|-------|------|------|--|
| | 2,00 | 2,10 | 2,20 | 2,30 | 2,40 | 2,50 | 2,60 | 2,70 | 2,80 | 2,90 | 3,00 | 3,10 | 3,20 | 3,30 | 3,40 | 3,50 | 3,60 | 3,70 | 3,80 | 3,90 | 4,00 | |
| 18 | 23,23 | 21,93 | 20,74 | 19,66 | 18,67 | 17,76 | 16,92 | 16,14 | 15,42 | 14,75 | 14,12 | 13,53 | 12,98 | 12,46 | 11,98 | 11,52 | 11,08 | 10,67 | 10,29 | 9,92 | 9,57 | |
| 17 | 21,93 | 20,71 | 19,59 | 18,57 | 17,63 | 16,77 | 15,98 | 15,24 | 14,56 | 13,93 | 13,33 | 12,78 | 12,26 | 11,77 | 11,31 | 10,88 | 10,47 | 10,08 | 9,71 | 9,36 | 9,03 | |
| 16 | 20,64 | 19,49 | 18,43 | 17,47 | 16,59 | 15,78 | 15,04 | 14,35 | 13,70 | 13,10 | 12,55 | 12,02 | 11,53 | 11,07 | 10,64 | 10,23 | 9,85 | 9,48 | 9,14 | 8,81 | 8,50 | |
| 15 | 19,35 | 18,26 | 17,28 | 16,38 | 15,55 | 14,8 | 14,09 | 13,45 | 12,84 | 12,28 | 11,76 | 11,27 | 10,81 | 10,38 | 9,97 | 9,59 | 9,23 | 8,89 | 8,56 | 8,26 | 7,96 | |
| 14 | 18,06 | 17,04 | 16,12 | 15,28 | 14,51 | 13,81 | 13,15 | 12,55 | 11,98 | 11,46 | 10,97 | 10,52 | 10,09 | 9,68 | 9,31 | 8,95 | 8,61 | 8,29 | 7,99 | 7,70 | 7,43 | |
| 13 | 16,76 | 15,82 | 14,97 | 14,19 | 13,47 | 12,82 | 12,21 | 11,65 | 11,12 | 10,64 | 10,19 | 9,76 | 9,36 | 8,99 | 8,64 | 8,31 | 7,99 | 7,70 | 7,42 | 7,15 | 6,90 | |
| 12 | 15,47 | 14,60 | 13,81 | 13,09 | 12,43 | 11,83 | 11,27 | 10,75 | 10,27 | 9,82 | 9,40 | 9,01 | 8,64 | 8,29 | 7,97 | 7,66 | 7,37 | 7,10 | 6,84 | 6,60 | - | |
| 11 | 14,18 | 13,38 | 12,66 | 12,00 | 11,39 | 10,84 | 10,32 | 9,85 | 9,41 | 9,00 | 8,61 | 8,25 | 7,92 | 7,60 | 7,30 | 7,02 | 6,76 | - | - | - | - | |
| 10 | 12,88 | 12,16 | 11,50 | 10,9 | 10,35 | 9,85 | 9,38 | 8,95 | 8,55 | 8,17 | 7,82 | 7,50 | 7,19 | 6,90 | - | - | - | - | - | - | - | |
| 9 | 11,59 | 10,94 | 10,35 | 9,81 | 9,31 | 8,86 | 8,44 | 8,05 | 7,69 | 7,35 | 7,04 | - | - | - | - | - | - | - | - | - | - | |
| | Without propping | With propping | | | | | | | | | | | | | | | | | | | | |

Multiple spans  with L1 = L2 and internal width support 100mm

| Thickness of the slab [cm] | Span [m] | | | | | | | | | | | | | | | | | | | | | |
|----------------------------|------------------|-------|-------|-------|-------|-------|-------|-------|-------|-------|---------------|-------|-------|-------|-------|-------|-------|-------|------|------|------|--|
| | 2,00 | 2,10 | 2,20 | 2,30 | 2,40 | 2,50 | 2,60 | 2,70 | 2,80 | 2,90 | 3,00 | 3,10 | 3,20 | 3,30 | 3,40 | 3,50 | 3,60 | 3,70 | 3,80 | 3,90 | 4,00 | |
| 18 | 26,22 | 24,78 | 23,46 | 22,27 | 21,17 | 20,16 | 19,22 | 18,36 | 17,56 | 16,81 | 16,12 | 15,46 | 14,85 | 13,72 | 12,69 | 11,75 | 10,88 | 10,08 | 9,34 | 8,66 | 8,03 | |
| 17 | 25 | 23,62 | 22,37 | 21,23 | 20,18 | 19,22 | 18,33 | 17,51 | 16,75 | 16,04 | 15,37 | 14,75 | 13,74 | 12,69 | 11,73 | 10,85 | 10,04 | 9,3 | 8,62 | 7,99 | 7,4 | |
| 16 | 23,73 | 22,43 | 21,24 | 20,16 | 19,17 | 18,26 | 17,41 | 16,63 | 15,91 | 15,24 | 14,61 | 13,69 | 12,62 | 11,65 | 10,77 | 9,95 | 9,21 | 8,52 | 7,89 | 7,31 | 6,77 | |
| 15 | 22,43 | 21,2 | 20,08 | 19,06 | 18,12 | 17,26 | 16,46 | 15,73 | 15,04 | 14,41 | 13,57 | 12,49 | 11,51 | 10,62 | 9,8 | 9,06 | 8,38 | 7,75 | 7,17 | 6,63 | 6,13 | |
| 14 | 21,08 | 19,92 | 18,87 | 17,91 | 17,03 | 16,22 | 15,47 | 14,78 | 14,14 | 13,35 | 12,27 | 11,28 | 10,39 | 9,58 | 8,84 | 8,16 | 7,54 | 6,97 | 6,44 | 5,95 | 5,5 | |
| 13 | 19,67 | 18,59 | 17,61 | 16,72 | 15,9 | 15,14 | 14,45 | 13,8 | 13,03 | 11,94 | 10,97 | 10,08 | 9,28 | 8,55 | 7,88 | 7,27 | 6,71 | 6,19 | 5,72 | 5,28 | 4,87 | |
| 12 | 18,2 | 17,21 | 16,3 | 15,47 | 14,71 | 14,01 | 13,37 | 12,58 | 11,5 | 10,54 | 9,67 | 8,88 | 8,16 | 7,51 | 6,92 | 6,37 | 5,87 | 5,41 | 4,99 | 4,6 | 4,24 | |
| 11 | 16,67 | 15,75 | 14,92 | 14,17 | 13,47 | 12,83 | 11,97 | 10,92 | 9,98 | 9,13 | 8,37 | 7,68 | 7,05 | 6,48 | 5,96 | 5,48 | 5,04 | 4,64 | 4,27 | 3,92 | - | |
| 10 | 13,99 | 13,00 | 11,64 | 10,45 | 9,41 | 8,49 | 7,68 | 6,96 | 6,31 | 5,72 | 5,2 | 4,72 | 4,29 | 3,9 | 3,54 | 3,21 | 2,91 | - | - | - | - | |
| 9 | 12,16 | 10,84 | 9,69 | 8,69 | 7,81 | 7,04 | 6,35 | 5,74 | 5,19 | 4,7 | 4,26 | 3,85 | 3,49 | - | - | - | - | - | - | - | - | |
| | Without propping | | | | | | | | | | With propping | | | | | | | | | | | |

| Key | Thickness [mm] |
|-------------------------------|----------------|
| Installation without propping | 0,75 |
| | 0,88 |
| | 1,00 |
| With propping | 0,75 |

Assumptions

- Concrete C25 / 30 (density: 25 kN / m³)
- Fire resistance REI30
- Deflection while pouring L / 180
- Deflection in service L / 350 if L < 3.5 m or (0.5 cm + L / 700) if L > 3.5 m
- Materials safety factors : yM=1.0, yC=1.5, yS=1.15
- Construction loads according to EN 1991-1-6 (Q_{ca} = 0,75 kN / m², Q_{cf} = 0,75 kN / m²)

Cofraplus® 45

Composite floor decking with trapezoidal section

Used as shuttering during pouring phase and as reinforcement during service phase thanks to its specific geometry, Cofraplus® 45 is a multi-use profile suitable for all types of construction.

This slim profile optimises the height of the slab, providing great advantage for residential project. Associated with organic coating in white color, it brings some additional light and provides an attractive soffit solution. It also offers good performances in fire condition.



Fire resistant



Lightweight

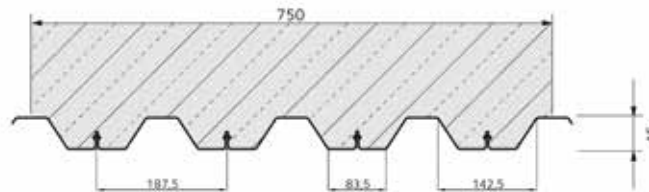

CE marking according to EN 1090-1

| Characteristics of the base material | | Norms |
|--------------------------------------|--------------------------------|--|
| Steel grade | S 350 GD | EN 10346 |
| Corrosion protection | Galvanised steel ZM 120 | P 34-310 ETPM ZMevolution® or AbZ Z-30.11-61 |
| | Galvanised coated steel ZM 120 | EN 10169+A1 |
| Organic coating | | Norms |
| Hairplus® 25 | Category CP13 | P 34-310 EN 10169+A1 |
| Other coatings | On demand | |

| Characteristics | Nominal thickness of the profile sheet [mm] |
|--|---|
| | 0,80 |
| Weight [kg / m ²] | 10,00 |
| Cross section A _p : [mm ² / m] | 1 088 |

Nominal concrete consumption

| | Thickness of the slab [cm] | | | | | | | | | | | | | | | |
|--|----------------------------|-----|-----|-----|-----|-----|-----|-----|-----|-----|-----|-----|-----|-----|-----|-----|
| | 8 | 10 | 12 | 14 | 16 | 18 | 20 | 22 | 24 | 26 | 28 | 30 | 32 | 34 | 36 | 38 |
| Concrete volume [l / m ²] | 62 | 82 | 102 | 122 | 142 | 162 | 182 | 202 | 222 | 242 | 262 | 282 | 302 | 322 | 342 | 362 |
| Theoretical weight* of the composite slab [kg / m ²] | 155 | 205 | 255 | 305 | 355 | 405 | 455 | 505 | 555 | 605 | 655 | 705 | 755 | 805 | 855 | 905 |

Concrete density 2500 kg / m³

*Additional weight du to pounding effect is not included

Fire resistance

| | REI [min] | | | |
|----------------------------|-----------|----|----|-----|
| | 30 | 60 | 90 | 120 |
| Thickness of the slab [cm] | 8 | 10 | 12 | 14 |

REI: fire protection rating of the raw composite slab

The minimum thickness is required to comply with the temperature criterion (I) on the non- fire exposed side.

According to EN 1994-1-2 §4.3.2, Cofraplus® 45 composite floors are rated REI 30 even without specific reinforcement in the ribs. For higher fire resistance classes, additional reinforcement bars are required. These are positioned in the ribs of the profile.

Structural performance

Load / Span table

The value provided in each cell of the table loads is the maximum live load capacity Q (kN / m²). The self weight of the slab is already included. The color of each cell give information about the required steel thickness.

Single span 

| Thickness of the slab [cm] | Span [m] | | | | | | | | | | | | | | | | | | | | |
|----------------------------|------------------|-------|-------|-------|-------|-------|------|------|------|------|---------------|------|------|------|------|------|------|------|------|------|------|
| | 1,50 | 1,60 | 1,70 | 1,80 | 1,90 | 2,00 | 2,10 | 2,20 | 2,30 | 2,40 | 2,50 | 2,60 | 2,70 | 2,80 | 2,90 | 3,00 | 3,10 | 3,20 | 3,30 | 3,40 | 3,50 |
| 18 | 16,85 | 15,13 | 13,66 | 12,39 | 11,29 | 10,32 | 9,46 | 8,70 | 8,01 | 7,40 | 6,84 | 6,34 | 5,87 | 5,45 | 5,06 | 4,70 | 4,36 | 4,04 | 3,74 | 3,47 | 3,21 |
| 17 | 16,18 | 14,52 | 13,10 | 11,87 | 10,81 | 9,87 | 9,05 | 8,31 | 7,65 | 7,06 | 6,53 | 6,04 | 5,60 | 5,20 | 4,82 | 4,48 | 4,15 | 3,84 | 3,56 | 3,30 | 3,05 |
| 16 | 15,51 | 13,90 | 12,53 | 11,35 | 10,33 | 9,43 | 8,63 | 7,93 | 7,30 | 6,73 | 6,22 | 5,75 | 5,33 | 4,94 | 4,58 | 4,26 | 3,94 | 3,65 | 3,38 | 3,12 | 2,89 |
| 15 | 14,84 | 13,29 | 11,97 | 10,83 | 9,85 | 8,98 | 8,22 | 7,54 | 6,94 | 6,39 | 5,90 | 5,46 | 5,05 | 4,68 | 4,35 | 4,03 | 3,73 | 3,45 | 3,19 | 2,95 | 2,73 |
| 14 | 14,17 | 12,68 | 11,41 | 10,31 | 9,37 | 8,54 | 7,80 | 7,16 | 6,58 | 6,06 | 5,59 | 5,17 | 4,78 | 4,43 | 4,11 | 3,81 | 3,52 | 3,25 | 3,01 | 2,78 | 2,57 |
| 13 | 13,51 | 12,07 | 10,84 | 9,79 | 8,88 | 8,09 | 7,39 | 6,77 | 6,22 | 5,72 | 5,28 | 4,87 | 4,51 | 4,17 | 3,87 | 3,58 | 3,31 | 3,06 | 2,83 | 2,61 | 2,41 |
| 12 | 12,84 | 11,45 | 10,28 | 9,27 | 8,40 | 7,64 | 6,98 | 6,39 | 5,86 | 5,39 | 4,97 | 4,58 | 4,23 | 3,92 | 3,63 | 3,36 | 3,10 | 2,86 | 2,64 | 2,44 | 2,25 |
| 11 | 12,17 | 10,84 | 9,72 | 8,75 | 7,92 | 7,20 | 6,56 | 6,00 | 5,50 | 5,05 | 4,65 | 4,29 | 3,96 | 3,66 | 3,39 | 3,14 | 2,89 | 2,67 | 2,46 | 2,27 | 2,09 |
| 10 | 11,50 | 10,23 | 9,15 | 8,23 | 7,44 | 6,75 | 6,15 | 5,62 | 5,14 | 4,72 | 4,34 | 4,00 | 3,69 | 3,41 | 3,15 | 2,91 | 2,68 | 2,47 | 2,28 | - | - |
| 9 | 10,83 | 9,62 | 8,59 | 7,71 | 6,96 | 6,31 | 5,73 | 5,23 | 4,78 | 4,38 | 4,03 | 3,71 | 3,42 | 3,15 | 2,91 | - | - | - | - | - | - |
| | Without propping | | | | | | | | | | With propping | | | | | | | | | | |

Multiple spans  with L1 = L2 and internal width support 100mm

| Thickness of the slab [cm] | span [m] | | | | | | | | | | | | | | | | | | | | |
|----------------------------|------------------|-------|-------|-------|-------|-------|-------|-------|-------|-------|---------------|------|------|------|------|------|------|------|------|------|------|
| | 1,50 | 1,60 | 1,70 | 1,80 | 1,90 | 2,00 | 2,10 | 2,20 | 2,30 | 2,40 | 2,50 | 2,60 | 2,70 | 2,80 | 2,90 | 3,00 | 3,10 | 3,20 | 3,30 | 3,40 | 3,50 |
| 18 | 22,00 | 19,91 | 18,12 | 16,57 | 15,22 | 14,04 | 12,99 | 12,06 | 11,23 | 10,48 | 9,80 | 9,18 | 8,62 | 8,10 | 7,63 | 7,19 | 6,77 | 6,38 | 6,02 | 5,68 | 5,37 |
| 17 | 21,10 | 19,07 | 17,34 | 15,85 | 14,55 | 13,41 | 12,40 | 11,51 | 10,71 | 9,98 | 9,33 | 8,74 | 8,20 | 7,71 | 7,25 | 6,83 | 6,43 | 6,06 | 5,71 | 5,39 | 5,09 |
| 16 | 20,20 | 18,24 | 16,57 | 15,13 | 13,88 | 12,78 | 11,81 | 10,95 | 10,18 | 9,49 | 8,86 | 8,30 | 7,78 | 7,31 | 6,88 | 6,47 | 6,09 | 5,73 | 5,40 | 5,09 | 4,81 |
| 15 | 19,30 | 17,41 | 15,80 | 14,41 | 13,21 | 12,15 | 11,22 | 10,40 | 9,66 | 8,99 | 8,40 | 7,86 | 7,36 | 6,91 | 6,50 | 6,11 | 5,75 | 5,41 | 5,09 | 4,80 | 4,53 |
| 14 | 18,40 | 16,57 | 15,02 | 13,69 | 12,53 | 11,52 | 10,63 | 9,84 | 9,13 | 8,50 | 7,93 | 7,41 | 6,94 | 6,51 | 6,12 | 5,76 | 5,40 | 5,08 | 4,78 | 4,50 | 4,25 |
| 13 | 17,50 | 15,74 | 14,25 | 12,97 | 11,86 | 10,89 | 10,04 | 9,28 | 8,61 | 8,01 | 7,46 | 6,97 | 6,52 | 6,12 | 5,74 | 5,40 | 5,06 | 4,76 | 4,47 | 4,21 | 3,96 |
| 12 | 16,60 | 14,91 | 13,48 | 12,25 | 11,19 | 10,26 | 9,45 | 8,73 | 8,09 | 7,51 | 7,00 | 6,53 | 6,10 | 5,72 | 5,36 | 5,04 | 4,72 | 4,43 | 4,16 | 3,91 | 3,68 |
| 11 | 15,69 | 14,07 | 12,70 | 11,53 | 10,51 | 9,63 | 8,86 | 8,17 | 7,56 | 7,02 | 6,53 | 6,09 | 5,68 | 5,32 | 4,99 | 4,68 | 4,38 | 4,11 | 3,85 | 3,62 | 3,40 |
| 10 | 14,79 | 13,24 | 11,93 | 10,81 | 9,84 | 9,00 | 8,26 | 7,61 | 7,04 | 6,52 | 6,06 | 5,64 | 5,27 | 4,92 | 4,61 | 4,32 | 4,04 | 3,78 | 3,54 | 3,32 | 3,12 |
| 9 | 13,89 | 12,41 | 11,16 | 10,09 | 9,17 | 8,37 | 7,67 | 7,06 | 6,51 | 6,03 | 5,59 | 5,20 | 4,85 | 4,52 | 4,23 | 3,96 | 3,70 | 3,46 | - | - | - |
| | Without propping | | | | | | | | | | With propping | | | | | | | | | | |

| Key | Thickness [mm] |
|-------------------------------|----------------|
| Installation without propping | 0,80 |
| With propping | 0,80 |

Assumptions

- Concrete C25 / 30 (density: 25 kN / m³)
- Fire resistance REI30
- Deflection while pouring L / 180
- Deflection in service L / 350 if L < 3.5 m or (0.5 cm + L / 700) if L > 3.5 m
- Materials safety factors : $\gamma_M=1.0$, $\gamma_C=1.5$, $\gamma_S=1.15$

Cofrastra® 56

Composite floors decking with dovetail section

With its optimised composite action, Cofrastra® 56 is a performant and slim solution, suitable for all kinds of general and industrial applications, in particular with heavy loads.

This traditional 600mm wide profile with a pitch of just 150 mm is proposed with different options like pre-punched version for composite beams or pre-painted version with one of our organic coatings for maximum versatility.



Fire resistant



Thin slab



Heavy loads



Industrial

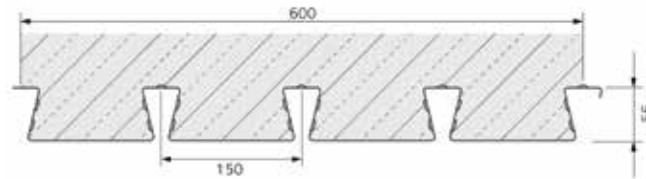

CE marking according to EN 1090-1
German technical approval: AbZ Z-16.1-22

| Characteristics of the base material | | Norms |
|--------------------------------------|--------------------------------|--|
| Steel grade | S 350 GD | EN 10346 |
| Corrosion protection | Galvanised steel ZM 175 | P 34-310 ETPM ZMevolution® or AbZ Z-30.11-61 |
| | Galvanised coated steel ZM 175 | EN 10169+A1 |
| Organic coating | | Norms |
| Hairplus® 25 | Category CPT3 | P 34-310 |
| | | EN 10169+A1 |
| Other coatings | On demand | |

| Characteristics | Nominal thickness of the profile sheet [mm] | | | | |
|--|---|-------|-------|-------|-------|
| | 0,75 | 0,88 | 1,00 | 1,13 | 1,25 |
| Weight [kg / m ²] | 11,60 | 13,60 | 15,50 | 17,50 | 19,40 |
| Cross section A _p : [mm ² / m] | 1 402 | 1 659 | 1 896 | 2 153 | 2 390 |
| Effective inertia I _{eff} : [cm ⁴ / m] | 47,10 | 61,30 | 74,40 | 84,40 | 93,60 |

Nominal concrete consumption

| | Thickness of the slab [cm] | | | | | | | | | | | | |
|--|----------------------------|-----|-----|-----|-----|-----|-----|-----|-----|-----|-----|-----|-----|
| | 11 | 12 | 13 | 14 | 15 | 16 | 17 | 18 | 19 | 20 | 22 | 25 | 30 |
| Concrete volume [l / m ²] | 100 | 110 | 120 | 130 | 140 | 150 | 160 | 170 | 180 | 190 | 210 | 240 | 290 |
| Theoretical weight* of the composite slab [kg / m ²] | 250 | 275 | 300 | 325 | 350 | 375 | 400 | 425 | 450 | 475 | 525 | 600 | 725 |

Concrete density 2500 kg / m³

Maximum recommended slab thickness d = 30 cm

*Additional weight du to pounding effect is not included

Cofrastra® 56P:

Pre-punched version, compatible with shear connectors, welded in advance or in shop to the composite beams.



Fire resistance

| | REI [min] | | | |
|----------------------------|-----------|----|----|-----|
| | 30 | 60 | 90 | 120 |
| Thickness of the slab [cm] | 11 | 11 | 12 | 14 |

REI: fire protection rating of the raw composite slab

The minimum thickness is required to comply with the temperature criterion (I) on the non- fire exposed side.

According to EN 1994-1-2 §4.3.2, Cofrastra® 56S composite floors are by default REI 30.

For higher fire resistance classes, reinforcement bars are required. These are positioned in the ribs of the profile. Their section is determined by using Cofra® 5.

Sound insulation

The acoustic behaviour of a raw composite slab is determined by its mass.

Given values are estimated performances based on the mass of the slab and similar modellings.

| | Thickness of the slab [cm] | | | | | | | |
|---------------|----------------------------|----------|----------|----------|----------|----------|----------|----------|
| | 11 | 12 | 13 | 14 | 15 | 16 | 17 | 18 |
| R_w [dB] | 48 | 49 | 50 | 50 | 51 | 52 | 52 | 53 |
| (C; Ctr) [dB] | (-2; -6) | (-2; -6) | (-1; -6) | (-1; -6) | (-1; -6) | (-2; -7) | (-1; -6) | (-2; -7) |

Structural performance

Load / Span table

The value provided in each cell of the table loads is the maximum live load capacity Q (kN / m²). The self weight of the slab is already included. The color of each cell give information about the required steel thickness.

A calculation using Cofra 5 optimises these values according to the project requirements.

Single span 

| Thickness of the slab [cm] | Span [m] | | | | | | | | | | | | | | | | | | | | |
|----------------------------|------------------|-------|-------|-------|-------|-------|-------|-------|-------|-------|-------|-------|-------|-------|-------|---------------|-------|-------|-------|-------|------|
| | 2,00 | 2,10 | 2,20 | 2,30 | 2,40 | 2,50 | 2,60 | 2,70 | 2,80 | 2,90 | 3,00 | 3,10 | 3,20 | 3,30 | 3,40 | 3,50 | 3,60 | 3,70 | 3,80 | 3,90 | 4,00 |
| 20 | 27,55 | 26,01 | 24,61 | 23,34 | 22,17 | 21,09 | 20,10 | 19,18 | 18,15 | 17,10 | 16,13 | 15,24 | 14,42 | 13,66 | 12,95 | 12,29 | 11,68 | 11,11 | 10,57 | 10,07 | 9,59 |
| 19 | 26,16 | 24,70 | 23,37 | 22,16 | 21,05 | 20,03 | 19,08 | 18,21 | 17,40 | 16,46 | 15,52 | 14,65 | 13,86 | 13,12 | 12,44 | 11,80 | 11,21 | 10,65 | 10,13 | 9,65 | 9,19 |
| 18 | 24,77 | 23,39 | 22,13 | 20,98 | 19,93 | 18,96 | 18,07 | 17,24 | 16,47 | 15,76 | 14,90 | 14,07 | 13,30 | 12,58 | 11,92 | 11,30 | 10,73 | 10,20 | 9,69 | 9,22 | 8,78 |
| 17 | 23,38 | 22,07 | 20,89 | 19,80 | 18,81 | 17,90 | 17,05 | 16,27 | 15,55 | 14,87 | 14,24 | 13,48 | 12,73 | 12,04 | 11,40 | 10,81 | 10,26 | 9,74 | 9,26 | 8,80 | 8,38 |
| 16 | 21,99 | 20,76 | 19,65 | 18,63 | 17,69 | 16,83 | 16,04 | 15,30 | 14,62 | 13,98 | 13,39 | 12,83 | 12,17 | 11,50 | 10,89 | 10,31 | 9,78 | 9,28 | 8,82 | 8,38 | 7,97 |
| 15 | 20,60 | 19,45 | 18,40 | 17,45 | 16,57 | 15,76 | 15,02 | 14,33 | 13,69 | 13,09 | 12,54 | 12,02 | 11,53 | 10,97 | 10,37 | 9,82 | 9,31 | 8,83 | 8,38 | 7,96 | 7,57 |
| 14 | 19,22 | 18,14 | 17,16 | 16,27 | 15,45 | 14,70 | 14,00 | 13,36 | 12,76 | 12,21 | 11,69 | 11,20 | 10,75 | 10,32 | 9,85 | 9,32 | 8,83 | 8,37 | 7,94 | 7,54 | 7,16 |
| 13 | 17,83 | 16,83 | 15,92 | 15,09 | 14,33 | 13,63 | 12,99 | 12,39 | 11,84 | 11,32 | 10,84 | 10,39 | 9,96 | 9,57 | 9,19 | 8,83 | 8,36 | 7,91 | 7,50 | 7,12 | 6,76 |
| 12 | 16,44 | 15,52 | 14,68 | 13,91 | 13,21 | 12,57 | 11,97 | 11,42 | 10,91 | 10,43 | 9,99 | 9,57 | 9,18 | 8,81 | 8,47 | 8,14 | 7,84 | 7,46 | 7,07 | 6,70 | 6,35 |
| 11 | 15,05 | 14,21 | 13,44 | 12,74 | 12,09 | 11,50 | 10,96 | 10,45 | 9,98 | 9,54 | 9,14 | 8,75 | 8,40 | 8,06 | 7,74 | 7,45 | 7,16 | 6,90 | 6,63 | 6,28 | 5,95 |
| | Without propping | | | | | | | | | | | | | | | With propping | | | | | |

Multiple spans  with $L_1 = L_2$ and internal width support 100mm

| Thickness of the slab [cm] | Span [m] | | | | | | | | | | | | | | | | | | | | |
|----------------------------|------------------|-------|-------|-------|-------|-------|-------|-------|-------|-------|-------|-------|-------|-------|-------|-------|-------|-------|-------|------|------|
| | 2,00 | 2,10 | 2,20 | 2,30 | 2,40 | 2,50 | 2,60 | 2,70 | 2,80 | 2,90 | 3,00 | 3,10 | 3,20 | 3,30 | 3,40 | 3,50 | 3,60 | 3,70 | 3,80 | 3,90 | 4,00 |
| 18 | 31,41 | 29,69 | 28,12 | 26,70 | 25,39 | 24,18 | 23,07 | 22,04 | 21,09 | 20,20 | 19,37 | 18,47 | 17,04 | 15,74 | 14,55 | 13,47 | 12,47 | 11,56 | 10,71 | 9,93 | 9,21 |
| 17 | 30,12 | 28,47 | 26,97 | 25,61 | 24,35 | 23,20 | 22,13 | 21,15 | 20,23 | 19,38 | 18,58 | 17,26 | 15,92 | 14,71 | 13,59 | 12,57 | 11,64 | 10,78 | 9,99 | 9,25 | 8,57 |
| 16 | 28,80 | 27,23 | 25,79 | 24,49 | 23,29 | 22,19 | 21,17 | 20,23 | 19,35 | 18,54 | 17,44 | 16,06 | 14,81 | 13,67 | 12,63 | 11,68 | 10,81 | 10,00 | 9,26 | 8,58 | 7,94 |
| 15 | 27,44 | 25,94 | 24,58 | 23,34 | 22,20 | 21,15 | 20,18 | 19,28 | 18,45 | 17,55 | 16,14 | 14,86 | 13,69 | 12,64 | 11,67 | 10,78 | 9,97 | 9,22 | 8,53 | 7,90 | 7,31 |
| 14 | 26,04 | 24,62 | 23,33 | 22,15 | 21,07 | 20,07 | 19,15 | 18,30 | 17,51 | 16,15 | 14,84 | 13,65 | 12,58 | 11,60 | 10,71 | 9,89 | 9,14 | 8,45 | 7,81 | 7,22 | 6,68 |
| 13 | 24,57 | 23,26 | 22,04 | 20,92 | 19,90 | 18,96 | 18,09 | 17,29 | 16,07 | 14,74 | 13,54 | 12,45 | 11,46 | 10,57 | 9,74 | 8,99 | 8,30 | 7,67 | 7,08 | 6,54 | 6,04 |
| 12 | 22,92 | 21,69 | 20,58 | 19,56 | 18,62 | 17,76 | 16,97 | 15,90 | 14,55 | 13,33 | 12,24 | 11,25 | 10,35 | 9,53 | 8,78 | 8,10 | 7,47 | 6,89 | 6,36 | 5,87 | 5,41 |
| 11 | 21,27 | 20,13 | 19,09 | 18,15 | 17,28 | 16,48 | 15,61 | 14,24 | 13,02 | 11,93 | 10,94 | 10,05 | 9,23 | 8,50 | 7,82 | 7,20 | 6,64 | 6,11 | 5,63 | 5,19 | 4,78 |
| 10 | 18,40 | 17,31 | 15,51 | 13,94 | 12,57 | 11,35 | 10,28 | 9,32 | 8,46 | 7,69 | 6,99 | 6,36 | 5,79 | 5,27 | 4,80 | 4,36 | 3,96 | 3,60 | 3,26 | 2,95 | 2,66 |
| 9 | 16,84 | 15,15 | 13,57 | 12,18 | 10,97 | 9,90 | 8,95 | 8,10 | 7,34 | 6,66 | 6,05 | 5,49 | 4,99 | 4,53 | 4,11 | 3,73 | 3,38 | 3,05 | 2,76 | 2,48 | 2,22 |
| | Without propping | | | | | | | | | | | | | | | | | | | | |

| Key | Thickness [mm] |
|-------------------------------|----------------|
| Installation without propping | 0,75 |
| | 0,88 |
| | 1,00 |
| | 1,13 |
| | 1,25 |
| With propping | 0,75 |

Assumptions

- Concrete C25 / 30 (density: 25 kN / m³)
- Fire resistance REI30
- Deflection while pouring $L / 180$
- Deflection in service $L / 350$ if $L < 3.5$ m or $(0.5 \text{ cm} + L / 700)$ if $L > 3.5$ m
- Materials safety factors : $\gamma_M=1.0$, $\gamma_C=1.5$, $\gamma_S=1.15$
- Construction loads according to EN 1991-1-6 ($Q_{ca} = 0,75 \text{ kN} / \text{m}^2$, $Q_{cf} = 0,75 \text{ kN} / \text{m}^2$)

Cofraplus® 60

Composite floor decking

Up to 30% lighter than traditional concrete slabs and easily stacked for efficient transportation and storage, Cofraplus® 60 composite slabs are a mainstream solution designed for medium load / span floors. It is ideal for all kinds of projects including refurbishments.

Cofraplus® 60 is proposed with two cover widths (1035 mm and 828 mm) for an optimized installation on site.

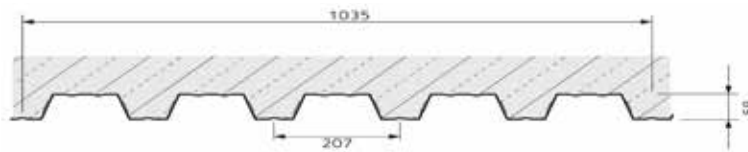

CE marking according to EN 1090-1

| Characteristics of the base material | | Norms |
|--------------------------------------|--------------------------------|--|
| Steel grade | S 350 GD | EN 10346 |
| Corrosion protection | Galvanised steel ZM 175 | P 34-310 ETPM ZMevolution® or AbZ Z-30.11-61 |
| | Galvanised coated steel ZM 175 | P 34-301 EN 10169+A1 |
| Organic coating | | Norms |
| Hairplus® 25 | Category CP13 | P 34-310 |
| Other coatings | | On demand |

| Characteristics | Nominal thickness of the profile sheet [mm] | | | |
|--|---|-------|-------|-------|
| | 0,75 | 0,88 | 1,00 | 1,25 |
| Weight [kg / m ²] | 8,53 | 10,00 | 11,37 | 14,22 |
| Cross section A _p [mm ² / m] | 1 029 | 1 217 | 1 391 | 1 797 |
| Effective inertia I _{eff} [cm ⁴ / m] | 44,37 | 52,64 | 60,08 | 75,10 |
| Height of neutral axis [mm] | 33,70 | 33,70 | 33,70 | 33,70 |
| Modulus of inertia [cm ³ / m] | 13,16 | 15,62 | 17,83 | 22,28 |

Cofraplus® 60P:

Pre-punched version, compatible with shear connectors welded in advance or in shop to composite beams.



Cofraplus® 60C:

If shear connectors are welded or nailed to the across the profile sheet to the beam, the Cofraplus® 60 C version brings advantages. The spacing between the 2 stiffeners in the lower flange permits to well position the connector.

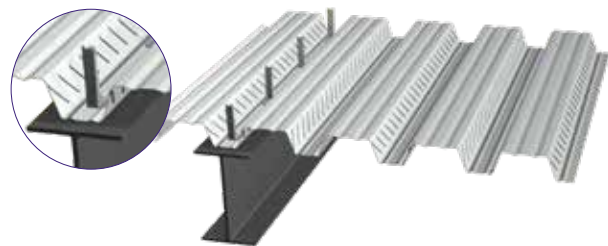

Nominal concrete consumption

| | Thickness of the slab [cm] | | | | | | | | | |
|--|----------------------------|-----|-----|-----|-----|-----|-----|-----|-----|-----|
| | 11 | 12 | 13 | 14 | 15 | 16 | 17 | 18 | 19 | 20 |
| Concrete volume [l / m ²] | 100 | 110 | 120 | 130 | 140 | 150 | 160 | 170 | 180 | 190 |
| Theoretical weight* of the composite slab [kg / m ²] | 250 | 275 | 300 | 325 | 350 | 375 | 400 | 425 | 450 | 475 |

Concrete density 2500 kg / m³

Maximum recommended slab thickness d = 30 cm

*Additional weight du to pounding effect is not included



Fire resistance

| | REI [min] | | | |
|----------------------------|-----------|----|----|-----|
| | 30 | 60 | 90 | 120 |
| Thickness of the slab [cm] | 11 | 12 | 14 | 16 |

REI: fire protection rating of the raw composite slab

The minimum thickness is required to comply with the temperature criterion (I) on the non-fire exposed side.

According to EN 1994-1-2 §4.3.2, Cofraplus® 60 composite floors are rated REI 30 even without specific reinforcement in the rib. For higher fire resistance classes, reinforcement bars are required. These are positioned in the ribs of the profile. Their section is determined by using Cofra® 5.

Sound insulation

The acoustic behaviour of a raw composite slab is determined by its mass.

Values calculated by modelling – study report CSTB No. AC15-26054708

| | Thickness of the slab [cm] | | | | | | | | |
|---------------|----------------------------|----------|----------|----------|----------|----------|----------|----------|----------|
| | 11 | 12 | 13 | 14 | 15 | 16 | 17 | 18 | 19 |
| R_w [dB] | 46 | 47 | 48 | 48 | 49 | 50 | 51 | 52 | 53 |
| (C; Ctr) [dB] | (-2; -6) | (-2; -6) | (-2; -6) | (-1; -6) | (-1; -6) | (-2; -6) | (-2; -7) | (-2; -7) | (-2; -7) |

Structural performance

Load / Span table

The value provided in each cell of the table loads is the maximum live load capacity Q (kN / m²). The self weight of the slab is already included. The color of each cell give information about the required steel thickness.

A calculation using Cofra 5 might optimise the given values according to the project requirements.

Single span 

| Thickness of the slab [cm] | Span [m] | | | | | | | | | | | | | | | | | | | | |
|----------------------------|------------------|------|------|------|------|------|------|------|------|------|---------------|------|------|------|------|------|------|------|------|------|------|
| | 2,00 | 2,10 | 2,20 | 2,30 | 2,40 | 2,50 | 2,60 | 2,70 | 2,80 | 2,90 | 3,00 | 3,10 | 3,20 | 3,30 | 3,40 | 3,50 | 3,60 | 3,70 | 3,80 | 3,90 | 4,00 |
| 20 | 9,20 | 8,57 | 8,00 | 7,48 | 7,00 | 6,56 | 6,15 | 5,78 | 5,43 | 5,11 | 4,80 | 4,52 | 4,25 | 4,00 | 3,77 | 3,55 | 3,34 | 3,14 | 2,95 | 2,78 | 2,61 |
| 19 | 8,76 | 8,17 | 7,62 | 7,13 | 6,68 | 6,26 | 5,87 | 5,52 | 5,18 | 4,88 | 4,59 | 4,32 | 4,07 | 3,83 | 3,61 | 3,40 | 3,20 | 3,01 | 2,83 | 2,66 | 2,50 |
| 18 | 8,33 | 7,76 | 7,25 | 6,78 | 6,35 | 5,96 | 5,59 | 5,25 | 4,94 | 4,65 | 4,37 | 4,12 | 3,88 | 3,66 | 3,44 | 3,24 | 3,06 | 2,88 | 2,71 | 2,55 | 2,40 |
| 17 | 7,89 | 7,36 | 6,88 | 6,43 | 6,03 | 5,65 | 5,31 | 4,99 | 4,69 | 4,42 | 4,16 | 3,92 | 3,69 | 3,48 | 3,28 | 3,09 | 2,92 | 2,75 | 2,59 | 2,44 | 2,29 |
| 16 | 7,46 | 6,96 | 6,50 | 6,08 | 5,70 | 5,35 | 5,03 | 4,73 | 4,45 | 4,19 | 3,95 | 3,72 | 3,51 | 3,31 | 3,12 | 2,94 | 2,77 | 2,62 | 2,47 | 2,32 | 2,19 |
| 15 | 7,03 | 6,56 | 6,13 | 5,74 | 5,38 | 5,05 | 4,75 | 4,46 | 4,20 | 3,96 | 3,73 | 3,52 | 3,32 | 3,13 | 2,96 | 2,79 | 2,63 | 2,48 | 2,34 | 2,21 | 2,08 |
| 14 | 6,59 | 6,15 | 5,75 | 5,39 | 5,05 | 4,75 | 4,46 | 4,20 | 3,96 | 3,73 | 3,52 | 3,32 | 3,13 | 2,96 | 2,79 | 2,64 | 2,49 | 2,35 | 2,22 | 2,10 | 1,98 |
| 13 | 6,16 | 5,75 | 5,38 | 5,04 | 4,73 | 4,45 | 4,18 | 3,94 | 3,71 | 3,50 | 3,30 | 3,12 | 2,95 | 2,78 | 2,63 | 2,49 | 2,35 | 2,22 | 2,10 | 1,99 | 1,88 |
| 12 | 5,72 | 5,35 | 5,01 | 4,69 | 4,41 | 4,14 | 3,90 | 3,67 | 3,47 | 3,27 | 3,09 | 2,92 | 2,76 | 2,61 | 2,47 | 2,34 | 2,21 | 2,09 | 1,98 | 1,87 | - |
| 11 | 5,29 | 4,95 | 4,63 | 4,35 | 4,08 | 3,84 | 3,62 | 3,41 | 3,22 | 3,04 | 2,87 | 2,72 | 2,57 | 2,44 | 2,31 | 2,18 | 2,07 | - | - | - | - |
| | Without propping | | | | | | | | | | With propping | | | | | | | | | | |

Multiple spans  with $L1 = L2$ and internal width support 100mm

| Thickness of the slab [cm] | Span [m] | | | | | | | | | | | | | | | | | | | | |
|----------------------------|------------------|-------|-------|------|------|------|------|------|------|------|---------------|------|------|------|------|------|------|------|------|------|------|
| | 2,00 | 2,10 | 2,20 | 2,30 | 2,40 | 2,50 | 2,60 | 2,70 | 2,80 | 2,90 | 3,00 | 3,10 | 3,20 | 3,30 | 3,40 | 3,50 | 3,60 | 3,70 | 3,80 | 3,90 | 4,00 |
| 20 | 11,65 | 10,93 | 10,28 | 9,68 | 9,14 | 8,63 | 8,17 | 7,74 | 7,34 | 6,97 | 6,63 | 6,30 | 6,00 | 5,71 | 5,45 | 5,19 | 4,95 | 4,73 | 4,51 | 4,31 | 4,12 |
| 19 | 11,09 | 10,41 | 9,79 | 9,22 | 8,70 | 8,23 | 7,79 | 7,38 | 7,00 | 6,65 | 6,32 | 6,01 | 5,72 | 5,45 | 5,20 | 4,96 | 4,73 | 4,51 | 4,31 | 4,12 | 3,93 |
| 18 | 10,53 | 9,88 | 9,29 | 8,76 | 8,27 | 7,82 | 7,40 | 7,01 | 6,65 | 6,32 | 6,01 | 5,72 | 5,44 | 5,19 | 4,95 | 4,72 | 4,50 | 4,30 | 4,11 | 3,92 | 3,75 |
| 17 | 9,97 | 9,36 | 8,80 | 8,30 | 7,83 | 7,41 | 7,01 | 6,65 | 6,31 | 5,99 | 5,70 | 5,42 | 5,17 | 4,92 | 4,70 | 4,48 | 4,28 | 4,08 | 3,90 | 3,73 | 3,57 |
| 16 | 9,41 | 8,83 | 8,31 | 7,83 | 7,40 | 7,00 | 6,63 | 6,28 | 5,96 | 5,67 | 5,39 | 5,13 | 4,89 | 4,66 | 4,45 | 4,24 | 4,05 | 3,87 | 3,70 | 3,54 | 3,38 |
| 15 | 8,85 | 8,31 | 7,82 | 7,37 | 6,96 | 6,59 | 6,24 | 5,92 | 5,62 | 5,34 | 5,08 | 4,84 | 4,61 | 4,40 | 4,20 | 4,01 | 3,83 | 3,66 | 3,50 | 3,34 | 3,20 |
| 14 | 8,29 | 7,78 | 7,33 | 6,91 | 6,53 | 6,18 | 5,85 | 5,55 | 5,27 | 5,01 | 4,77 | 4,55 | 4,33 | 4,13 | 3,95 | 3,77 | 3,60 | 3,44 | 3,29 | 3,15 | 3,01 |
| 13 | 7,73 | 7,26 | 6,84 | 6,45 | 6,09 | 5,77 | 5,47 | 5,19 | 4,93 | 4,69 | 4,46 | 4,25 | 4,05 | 3,87 | 3,69 | 3,53 | 3,37 | 3,23 | 3,09 | 2,96 | 2,83 |
| 12 | 7,17 | 6,74 | 6,34 | 5,99 | 5,66 | 5,36 | 5,08 | 4,82 | 4,58 | 4,36 | 4,15 | 3,96 | 3,78 | 3,61 | 3,44 | 3,29 | 3,15 | 3,01 | 2,89 | 2,76 | 2,65 |
| 11 | 6,61 | 6,21 | 5,85 | 5,53 | 5,22 | 4,95 | 4,69 | 4,46 | 4,24 | 4,03 | 3,84 | 3,67 | 3,5 | 3,34 | 3,19 | 3,06 | 2,92 | 2,80 | 2,68 | 2,46 | - |
| | Without propping | | | | | | | | | | With propping | | | | | | | | | | |

| Key | Thickness [mm] |
|-------------------------------|----------------|
| Installation without propping | 0,75 |
| | 0,88 |
| | 1,00 |
| With propping | 0,75 |

Assumptions

- Concrete C25 / 30 (density: 25 kN / m³)
- Fire resistance REI30
- Deflection while pouring $L / 180$
- Deflection in service $L / 350$ if $L < 3.5$ m or $(0.5 \text{ cm} + L / 700)$ if $L > 3.5$ m
- Materials safety factors : $\gamma_M=1.0$, $\gamma_C=1.5$, $\gamma_S=1.15$
- Construction loads according to EN 1991-1-6 ($Q_{ca} = 0,75 \text{ kN} / \text{m}^2$, $Q_{cf} = 0,75 \text{ kN} / \text{m}^2$)

Cofraplus® 80

Composite floors decking with trapezoidal section

With its embossments and its dovetail geometry, Cofraplus® 80 is a performant composite slab solution, ideal alternative to precast slab.

Its lightness, its stackable design and its flexibility offers numerous of advantages not only from a mechanical point of view but also logistical and economical as well.

Cofraplus® 80 is compatible with all structural materials. Its specific accessories allow suspended options such as ceiling or ducts without any drillings.

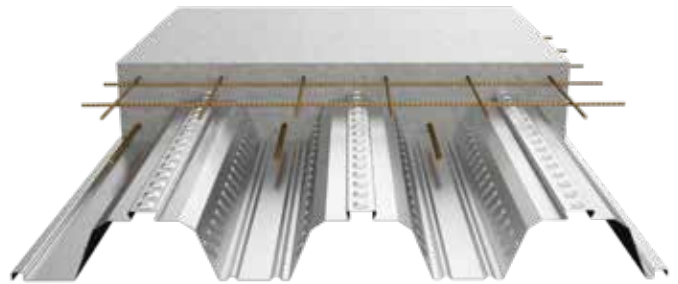

Fire resistant



Long span



Economic

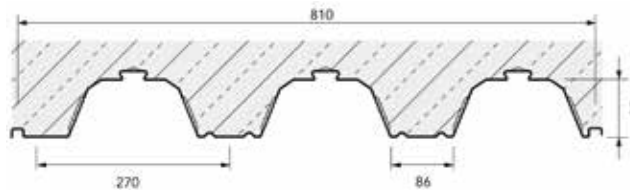

CE marking according to EN 1090-1

| Characteristics of the base material | | Norms |
|--------------------------------------|-------------------------|-------------------------------------|
| Steel grade | S 350 GD | EN 10346 |
| Corrosion protection | Galvanised steel ZM 175 | ETPM ZMevolution® or AbZ Z-30.11-61 |

| Characteristics | Nominal thickness of the profile sheet [mm] | | | |
|--|---|--------|--------|--------|
| | 0,75 | 0,88 | 1,00 | 1,25 |
| Weight [kg / m ²] | 10,66 | 12,11 | 13,69 | 15,14 |
| Cross section A _c : [mm ² / m] | 1 296 | 1 481 | 1 682 | 1 867 |
| Effective inertia I _{eff} : [cm ⁴ / m] | 141,58 | 158,79 | 177,43 | 194,64 |
| Height of neutral axis [mm] | 48,02 | 48,02 | 48,02 | 48,02 |
| Modulus of inertia [cm ³ / m] | 29,84 | 33,07 | 36,95 | 40,53 |

Nominal concrete consumption

| | Thickness of the slab [cm] | | | | | | | | | | | | |
|--|----------------------------|-----|-----|-----|-----|-----|-----|-----|-----|-----|-----|-----|-----|
| | 13 | 14 | 15 | 16 | 17 | 18 | 19 | 20 | 21 | 22 | 24 | 26 | 28 |
| Concrete volume [l / m ²] | 85 | 95 | 105 | 115 | 125 | 135 | 145 | 155 | 165 | 175 | 195 | 215 | 235 |
| Theoretical weight* of the composite slab [kg / m ²] | 213 | 238 | 263 | 288 | 313 | 338 | 363 | 388 | 413 | 438 | 488 | 538 | 588 |

Concrete density 2500 kg / m³

Maximum recommended slab thickness d = 20 cm

*Additional weight du to pounding effect is not included

- Able to reach spans:
- Up to 4,5 m without props
- Up to 6,5 m with props

Reduces by 15% the CO2 emission and 30% lighter compared to a precast solution.

Flexible, sustainable and easy to install, Cofraplus® 80 is adapted to every kind of modern construction project.

Cofraplus® 80P:

Pre-punched version, compatible with shear connectors, welded in advance or in shop to the composite beams.



Fire resistance

| | REI [min] | | | |
|----------------------------|-----------|----|----|-----|
| | 30 | 60 | 90 | 120 |
| Thickness of the slab [cm] | 14 | 14 | 15 | 17 |

REI: fire protection rating of the raw composite slab

The minimum thickness is required to comply with the temperature criterion (I) on the non- fire exposed side.

According to EN 1994-1-2 §4.3.2, Cofraplus® 80 composite floors are rated REI 30 even without specific reinforcement in the ribs. For higher fire resistance classes, additional reinforcement bars are required. These are positioned in the ribs of the profile. Their section is determined by using Cofra®5.

Sound insulation

The acoustic behaviour of a raw composite slab is determined by its mass.

Values calculated by modelling – study report
CSTB No. AC15-26054708

| | Thickness of the slab [cm] | | | | | | | | | |
|---------------------|----------------------------|----------|----------|----------|----------|----------|----------|----------|----------|----------|
| | 13 | 14 | 15 | 16 | 18 | 20 | 22 | 24 | 26 | 28 |
| R _w [dB] | 48 | 49 | 50 | 50 | 52 | 53 | 54 | 55 | 56 | 57 |
| (C; Ctr) [dB] | (-2; -6) | (-2; -6) | (-2; -7) | (-1; -6) | (-2; -7) | (-2; -7) | (-1; -7) | (-1; -7) | (-1; -7) | (-1; -7) |

Structural performance

Load / Span table

Design is made according to the Eurocodes.

The value provided in each cell of the table loads is the maximum live load capacity Q (kN / m²), with no safety factor. The self weight of the slab is already included.

The color of each cell give information about the required steel thickness.

A calculation using Cofra® 5 optimises these values according to the project requirements.

Single span 

| Thickness of the slab [cm] | Span [m] | | | | | | | | | | | | | | | | | | | | |
|----------------------------|------------------|------|------|------|------|------|------|------|------|------|---------------|------|------|------|------|------|------|------|------|------|------|
| | 3,00 | 3,10 | 3,20 | 3,30 | 3,40 | 3,50 | 3,60 | 3,70 | 3,80 | 3,90 | 4,00 | 4,10 | 4,20 | 4,30 | 4,40 | 4,50 | 4,60 | 4,70 | 4,80 | 4,90 | 5,00 |
| 22 | 5,82 | 5,49 | 5,19 | 4,90 | 4,63 | 4,37 | 4,13 | 3,90 | 3,68 | 3,48 | 3,28 | 3,10 | 2,92 | 2,75 | 2,59 | 2,44 | 2,29 | 2,15 | 2,01 | 1,88 | 1,76 |
| 21 | 5,75 | 5,43 | 5,13 | 4,85 | 4,59 | 4,34 | 4,11 | 3,89 | 3,68 | 3,48 | 3,29 | 3,11 | 2,93 | 2,77 | 2,61 | 2,46 | 2,32 | 2,19 | 2,05 | 1,93 | 1,81 |
| 20 | 5,68 | 5,37 | 5,08 | 4,81 | 4,55 | 4,31 | 4,09 | 3,87 | 3,67 | 3,47 | 3,29 | 3,11 | 2,95 | 2,79 | 2,64 | 2,49 | 2,35 | 2,22 | 2,09 | 1,97 | 1,85 |
| 19 | 5,43 | 5,13 | 4,86 | 4,6 | 4,36 | 4,13 | 3,91 | 3,71 | 3,51 | 3,33 | 3,15 | 2,99 | 2,83 | 2,68 | 2,54 | 2,40 | 2,27 | 2,14 | 2,02 | 1,90 | 1,79 |
| 18 | 5,17 | 4,89 | 4,63 | 4,39 | 4,16 | 3,94 | 3,74 | 3,54 | 3,36 | 3,19 | 3,02 | 2,86 | 2,71 | 2,57 | 2,43 | 2,30 | 2,18 | 2,06 | 1,95 | 1,84 | 1,73 |
| 17 | 4,92 | 4,66 | 4,41 | 4,18 | 3,96 | 3,76 | 3,57 | 3,38 | 3,21 | 3,04 | 2,89 | 2,74 | 2,60 | 2,46 | 2,33 | 2,21 | 2,09 | 1,98 | 1,87 | 1,77 | 1,67 |
| 16 | 4,67 | 4,42 | 4,19 | 3,97 | 3,77 | 3,57 | 3,39 | 3,22 | 3,06 | 2,9 | 2,75 | 2,61 | 2,48 | 2,35 | 2,23 | 2,12 | 2,01 | 1,90 | 1,80 | 1,70 | 1,61 |
| 15 | 4,41 | 4,18 | 3,97 | 3,76 | 3,57 | 3,39 | 3,22 | 3,06 | 2,90 | 2,76 | 2,62 | 2,49 | 2,36 | 2,25 | 2,13 | 2,02 | 1,92 | 1,82 | 1,72 | 1,63 | 1,55 |
| 14 | 4,16 | 3,94 | 3,74 | 3,55 | 3,37 | 3,20 | 3,05 | 2,89 | 2,75 | 2,62 | 2,49 | 2,36 | 2,25 | 2,14 | 2,03 | 1,93 | 1,83 | 1,74 | 1,65 | 1,57 | 1,48 |
| 13 | 3,91 | 3,71 | 3,52 | 3,34 | 3,18 | 3,02 | 2,87 | 2,73 | 2,6 | 2,47 | 2,35 | 2,24 | 2,13 | 2,03 | 1,93 | 1,84 | 1,75 | 1,66 | 1,58 | 1,50 | 1,42 |
| | Without propping | | | | | | | | | | With propping | | | | | | | | | | |

Multiple spans  with L1 = L2 and internal width support 100mm

| Thickness of the slab [cm] | Span [m] | | | | | | | | | | | | | | | | | | | | |
|----------------------------|------------------|------|-------|-------|-------|-------|------|------|------|------|------|------|------|------|------|------|------|------|------|---------------|------|
| | 3,00 | 3,10 | 3,20 | 3,30 | 3,40 | 3,50 | 3,60 | 3,70 | 3,80 | 3,90 | 4,00 | 4,10 | 4,20 | 4,30 | 4,40 | 4,50 | 4,60 | 4,70 | 4,80 | 4,90 | 5,00 |
| 22 | 7,89 | 7,51 | 7,16 | 6,83 | 6,52 | 6,23 | 5,95 | 5,69 | 5,45 | 5,21 | 4,99 | 4,78 | 4,57 | 4,38 | 4,20 | 4,02 | 3,85 | 3,69 | 3,54 | 3,39 | 3,25 |
| 21 | 7,75 | 7,38 | 7,04 | 6,72 | 6,42 | 6,14 | 5,87 | 5,61 | 5,37 | 5,15 | 4,93 | 4,72 | 4,53 | 4,34 | 4,16 | 3,99 | 3,83 | 3,67 | 3,52 | 3,38 | 3,24 |
| 20 | 7,60 | 7,25 | 12,50 | 6,61 | 6,31 | 6,04 | 5,78 | 5,53 | 5,30 | 5,08 | 4,87 | 4,67 | 4,48 | 4,30 | 4,12 | 3,96 | 3,80 | 3,65 | 3,5 | 3,36 | 3,23 |
| 19 | 7,25 | 6,91 | 12,04 | 11,56 | 6,02 | 5,76 | 5,52 | 5,28 | 5,06 | 4,85 | 4,65 | 4,46 | 4,28 | 4,11 | 3,94 | 3,79 | 3,63 | 3,49 | 3,35 | 3,22 | 3,09 |
| 18 | 6,89 | 6,57 | 11,56 | 11,11 | 10,68 | 10,28 | 5,25 | 5,03 | 4,82 | 4,62 | 4,43 | 4,25 | 4,08 | 3,92 | 3,76 | 3,61 | 3,47 | 3,34 | 3,20 | 3,08 | 2,96 |
| 17 | 6,54 | 6,24 | 11,07 | 10,64 | 10,23 | 9,85 | 9,48 | 4,78 | 4,58 | 4,40 | 4,22 | 4,05 | 3,88 | 3,73 | 3,58 | 3,44 | 3,31 | 3,18 | 3,06 | 2,94 | 2,82 |
| 16 | 6,18 | 5,90 | 5,64 | 9,82 | 9,44 | 9,09 | 8,65 | 8,03 | 4,34 | 4,17 | 4,00 | 3,84 | 3,69 | 3,54 | 3,40 | 3,27 | 3,14 | 3,02 | 2,91 | 2,80 | 2,69 |
| 15 | 5,83 | 5,57 | 5,32 | 5,09 | 4,87 | 8,24 | 7,82 | 7,25 | 6,73 | 3,94 | 3,78 | 3,63 | 3,49 | 3,35 | 3,22 | 3,10 | 2,98 | 2,87 | 2,76 | 2,65 | 2,55 |
| 14 | 5,48 | 5,23 | 5,00 | 4,78 | 4,58 | 4,39 | 5,16 | 4,75 | 4,37 | 4,02 | 3,57 | 3,40 | 3,12 | 2,86 | 2,62 | 2,39 | 2,18 | 1,98 | 1,80 | 1,62 | 1,46 |
| 13 | 5,12 | 4,90 | 4,68 | 4,48 | 4,29 | 4,11 | 3,94 | 3,78 | 3,87 | 3,56 | 3,27 | 3,00 | 2,75 | 2,52 | 2,30 | 2,10 | 1,91 | 1,73 | 1,57 | 1,41 | 1,26 |
| | Without propping | | | | | | | | | | | | | | | | | | | With propping | |

| Key | Thickness [mm] |
|-------------------------------|----------------|
| Installation without propping | 0,88 |
| | 1,00 |
| | 1,13 |
| | 1,25 |
| With propping | 0,88 |

Assumptions

- Concrete C25 / 30 (density: 25 kN / m³)
- Fire resistance REI30
- Deflection while pouring L / 180
- Deflection in service L / 350 if L < 3.5 m or (0.5 cm + L / 700) if L > 3.5 m
- Materials safety factors : yM=1.0, yC=1.5, yS=1.15
- Construction loads according to EN 1991-1-6 (Q_{ca} = 0,75 kN / m², Q_{cf} = 0,75 kN / m²)

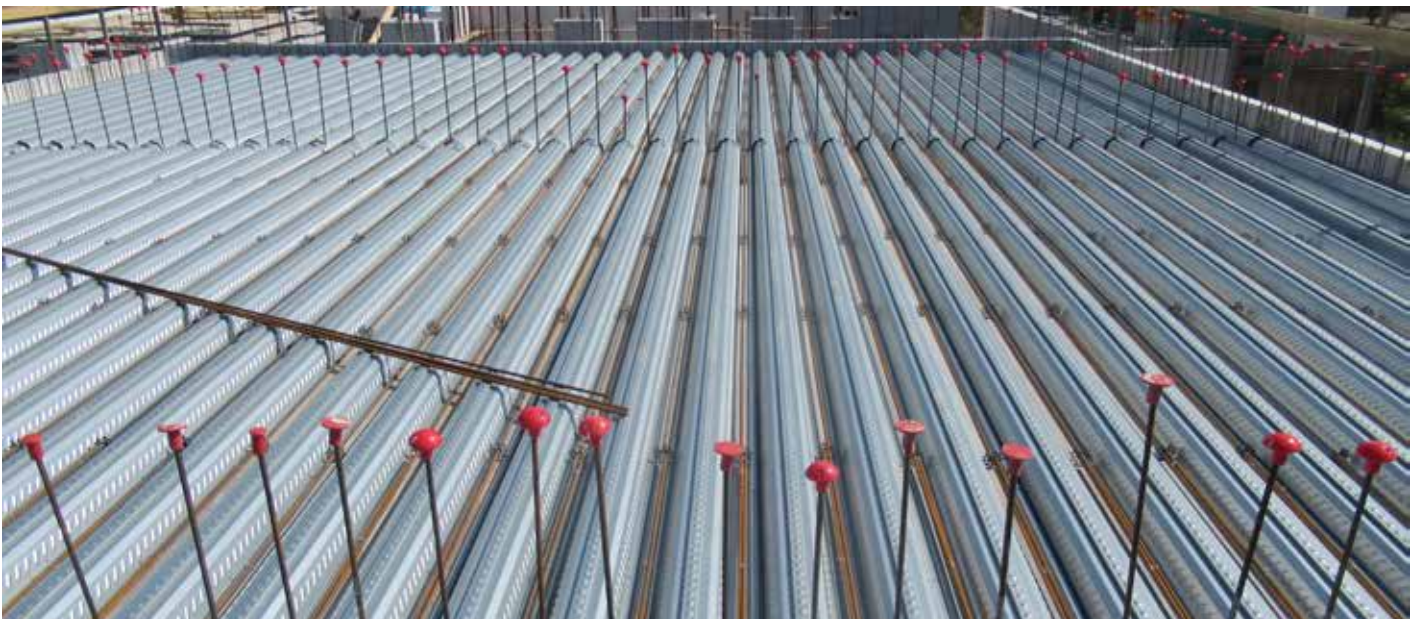



Cofraplus® 220

Long span floor decking

Quick and easy to install, our additive floor Cofraplus® 220 provides an optimised solution for long span applications such as tertiary sectors or multi-storey building. As it can easily reach spans up to 5 m without props, Cofraplus® 220 is particularly adapted to car park project.

A range of support accessories makes it easy to optimise the height of the slab and beam as required and ArcelorMittal Construction's organic coatings offer a large choice of colours.



Fire resistant



Long span



Slimfloor



Composite floor parking

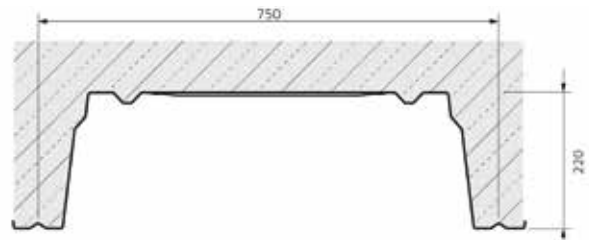

CE marking according to EN 1090-1
 French technical approval: DTA 3.1/17-927_V3
 German technical approval: AbZ Z-26.1-55

| Characteristics of the base material | | Norms |
|--------------------------------------|--|--|
| Steel grade | S 350 GD | EN 10346 |
| Corrosion protection | Galvanised steel ZM 175 | P 34-310 ETPM ZMevolution® or AbZ Z-30.11-61 |
| | Galvanised steel ZM 175 with organic coating | P 34-301 EN 10169+A1 |
| Organic coating | | Norms |
| Hairplus® 25 | Category CP13 | P 34-310 EN 10169+A1 |
| Other coatings | | On demand |

| Characteristics | Nominal thickness of the profile sheet [mm] | |
|--|---|--------|
| | 1,13 | 1,25 |
| Weight [kg / m ²] | 15,14 | 16,75 |
| Cross section A _p : [mm ² / m] | 1 817 | 2 017 |
| Effective inertia I _{eff} : [cm ⁴ / m] | 926 | 1063 |
| Height of neutral axis [mm] | 159,90 | 159,90 |
| Modulus of inertia [cm ³ / m] | 57,91 | 66,48 |

Possibility of bridging large spans

- Up to 5,5 m without props
- Up to 8,5 m with props

Considerable flexibility in use: the profile's lightness (12,5 kg / ml) makes it easy to handle, thus reducing the costs of lifting devices for installation.

Compatibility with steel, concrete or timber frame for better adaptability.

Nominal concrete consumption

| | Thickness of the slab [cm] | | | | | | | |
|--|----------------------------|-----|-----|-----|-----|-----|-----|-----|
| | 80 | 90 | 100 | 110 | 120 | 130 | 140 | 150 |
| Concrete volume [l / m ²] | 117 | 127 | 137 | 147 | 157 | 167 | 177 | 187 |
| Theoretical weight* of the composite slab [kg / m ²] | 308 | 333 | 358 | 383 | 408 | 433 | 458 | 483 |

Concrete density 2500 kg / m³
 Maximum recommended slab thickness d = 20 cm
 *Additional weight du to pounding effect is not included

Fire resistance

| | REI [min] | | | |
|-----------------|-----------|----|----|-----|
| | 30 | 60 | 90 | 120 |
| h_c mini [cm] | 8 | 8 | 10 | 12 |

The section of reinforcement get calculated according the project specifications.
A specific calculation note for a pre-design will be communicated by our consultant engineers.

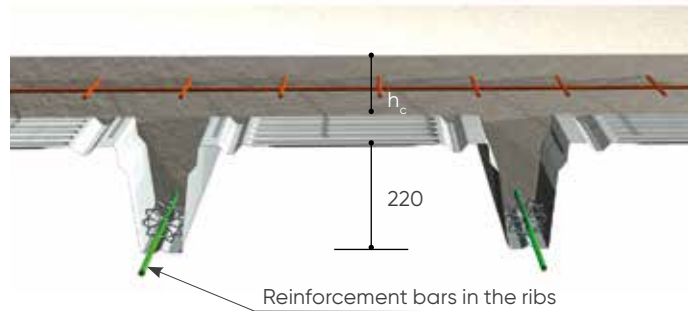

Structural performance

Load / Span table

The value provided in each cell of the table loads is the maximum live load capacity Q (kN / m²), with no safety factor.
The self weight of the slab is already included.

The color of each cell give information about the required steel thickness.

Our engineering design office will be able to refine these indications based on the detailed specifications of your project

Single span 

| Thickness of the slab [cm] | Span [m] | | | | | | | | | | | | | | | | | | | | |
|-----------------------------|------------------|------|------|------|------|--------|------|------|------|------|---------------|------|------|------|------|--------|------|------|------|------|------|
| | 5,00 | 5,10 | 5,20 | 5,30 | 5,40 | 5,50 | 5,60 | 5,70 | 5,80 | 5,90 | 6,00 | 6,20 | 6,40 | 6,60 | 6,80 | 7,00 | 7,20 | 7,40 | 7,60 | 7,80 | 8,00 |
| 15 | 7,38 | 6,39 | 6,37 | 6,34 | 6,32 | 7,12 | 7,37 | 6,97 | 6,58 | 6,21 | 5,86 | 8,09 | 7,33 | 6,63 | 5,55 | 5 | 7,72 | 7,45 | 6,84 | 6,27 | 5,75 |
| 14 | 7,43 | 6,95 | 6,44 | 6,42 | 6,4 | 7,93 | 6,74 | 6,37 | 6,62 | 6,26 | 5,92 | 8,06 | 7,31 | 6,63 | 6,01 | 5,03 | 7,65 | 7,03 | 6,8 | 6,25 | 5,73 |
| 13 | 7,47 | 7 | 6,56 | 6,5 | 6,48 | 7,96 | 7,93 | 6,4 | 6,05 | 5,72 | 5,4 | 8,04 | 7,3 | 6,63 | 6,03 | 5,47 | 7,98 | 6,97 | 6,41 | 5,89 | 5,72 |
| 12 | 7,52 | 7,06 | 6,62 | 5,84 | 6,56 | 7,99 | 7,97 | 7,94 | 6,09 | 5,76 | 5,45 | 7,48 | 7,29 | 6,64 | 6,04 | 5,49 | 7,91 | 7,29 | 6,37 | 5,87 | 5,4 |
| 11 | 7,57 | 7,12 | 6,69 | 5,91 | 5,89 | 8,02 | 8 | 7,98 | 7,95 | 5,81 | 5,5 | 7,45 | 6,78 | 6,17 | 6,06 | 5,52 | 7,84 | 7,24 | 6,68 | 6,17 | 5,38 |
| 10 | 7,62 | 7,18 | 6,75 | 5,99 | 5,97 | 7,31 | 8,03 | 8,01 | 7,99 | 7,96 | 5,56 | 7,42 | 6,77 | 6,17 | 5,63 | 5,55 | 7,77 | 7,19 | 6,65 | 6,15 | 5,69 |
| 9 | 7,67 | 7,23 | 6,82 | 6,07 | 6,05 | 7,34 | 7,32 | 7,29 | 8,02 | 8 | 7,97 | 7,39 | 6,75 | 6,17 | 5,64 | 5,16 | 7,31 | 7,13 | 6,61 | 6,13 | 5,67 |
| 8 | 7,72 | 7,29 | 6,89 | 6,15 | 6,14 | 7,37 | 7,35 | 7,33 | 7,31 | 8,03 | 8,01 | 7,96 | 6,74 | 6,18 | 5,67 | 5,19 | 7,25 | 6,71 | 6,57 | 6,1 | 5,66 |
| Steel reinforcement per rib | 1 HA 14 | | | | | 1 HA16 | | | | | 1 HA20 | | | | | 1 HA25 | | | | | |
| | Without propping | | | | | | | | | | With propping | | | | | | | | | | |

Multiple spans  with $L1 = L2$ and internal width support 100mm

| Thickness of the slab [cm] | Span [m] | | | | | | | | | | | | | | | | | | | | |
|-----------------------------|------------------------------------|-------|-------|-------|------|--------|------|------|------|------|------------------------------------|-------|------|------|------|--------|------|------|------|------|------|
| | 5,00 | 5,10 | 5,20 | 5,30 | 5,40 | 5,50 | 5,60 | 5,70 | 5,80 | 5,90 | 6,00 | 6,20 | 6,40 | 6,60 | 6,80 | 7,00 | 7,20 | 7,40 | 7,60 | 7,80 | 8,00 |
| 15 | 11,54 | 11,46 | 10,83 | 10,23 | 9,66 | 9,49 | 8,98 | 8,52 | 8,08 | 7,66 | 7,27 | 10,48 | 9,57 | 8,74 | 7,99 | 7,3 | 6,66 | 6,06 | 5,52 | 5,02 | 4,56 |
| 14 | 11,49 | 10,89 | 10,55 | 9,97 | 9,42 | 8,9 | 8,78 | 8,33 | 7,89 | 7,49 | 7,1 | 10,16 | 9,28 | 8,49 | 7,76 | 7,1 | 6,49 | 5,93 | 5,39 | 4,91 | 4,46 |
| 13 | 11,44 | 10,84 | 10,25 | 9,71 | 9,18 | 8,68 | 8,2 | 8,11 | 7,71 | 7,32 | 6,95 | 9,85 | 9 | 8,23 | 7,53 | 6,89 | 6,3 | 5,77 | 5,27 | 4,81 | 4,36 |
| 12 | 11,15 | 10,55 | 9,98 | 9,43 | 8,94 | 8,46 | 7,99 | 7,55 | 7,52 | 7,15 | 6,79 | 9,55 | 8,72 | 7,98 | 7,31 | 6,69 | 6,12 | 5,6 | 5,14 | 4,69 | 4,28 |
| 11 | 10,83 | 10,25 | 9,7 | 9,18 | 8,68 | 8,24 | 7,79 | 7,37 | 7,33 | 6,97 | 6,63 | 9,24 | 8,46 | 7,75 | 7,09 | 6,49 | 5,95 | 5,45 | 4,99 | 4,56 | 4,19 |
| 10 | 10,51 | 9,95 | 9,42 | 8,92 | 8,45 | 8 | 7,57 | 7,18 | 7,14 | 6,42 | 6,46 | 8,92 | 8,18 | 7,5 | 6,88 | 6,3 | 5,78 | 5,3 | 4,86 | 4,45 | 4,07 |
| 9 | 10,19 | 9,65 | 9,15 | 8,67 | 8,21 | 7,78 | 7,37 | 6,97 | 6,95 | 6,27 | 5,93 | 8,61 | 7,9 | 7,25 | 6,66 | 6,11 | 5,62 | 5,14 | 4,72 | 4,33 | 3,97 |
| 8 | 9,87 | 9,36 | 8,87 | 8,41 | 7,98 | 7,56 | 7,17 | 6,79 | 6,43 | 6,12 | 5,79 | 7,9 | 7,62 | 7 | 6,43 | 5,92 | 5,44 | 5,01 | 4,6 | 4,22 | 3,88 |
| Steel reinforcement per rib | 1 HA14 | | | | | 1 HA16 | | | | | 1 HA20 | | | | | 1 HA25 | | | | | |
| | 503mm ² / ml on support | | | | | | | | | | 760mm ² / ml on support | | | | | | | | | | |
| | Without propping | | | | | | | | | | With propping | | | | | | | | | | |

| Key | Thickness [mm] |
|-------------------------------|----------------|
| Installation without propping | 1,13 |
| | 1,25 |
| With 2 props | 1,13 |
| | 1,25 |
| With 3 props | 1,13 |
| | 1,25 |

Assumptions

- Concrete C25 / 30 (density: 25 kN / m³)
- Fire resistance REI30
- Deflection while pouring $L / 180$
- Deflection in service $L / 350$ if $L < 3.5$ m or $(0.5 \text{ cm} + L / 700)$ if $L > 3.5$ m
- Materials safety factors : $\gamma_M=1.0$, $\gamma_C=1.5$, $\gamma_S=1.15$
- Construction loads according to EN 1991-1-6 ($Q_{ca} = 0,75 \text{ kN / m}^2$, $Q_{cf} = 0,75 \text{ kN / m}^2$)

Cofraplus[®] 220

Long span floor decking

Wing system

Wings are consoles which can be welded to the web of the beam in shop or bolted on site.

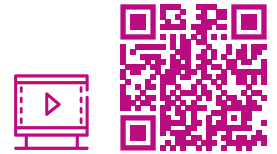
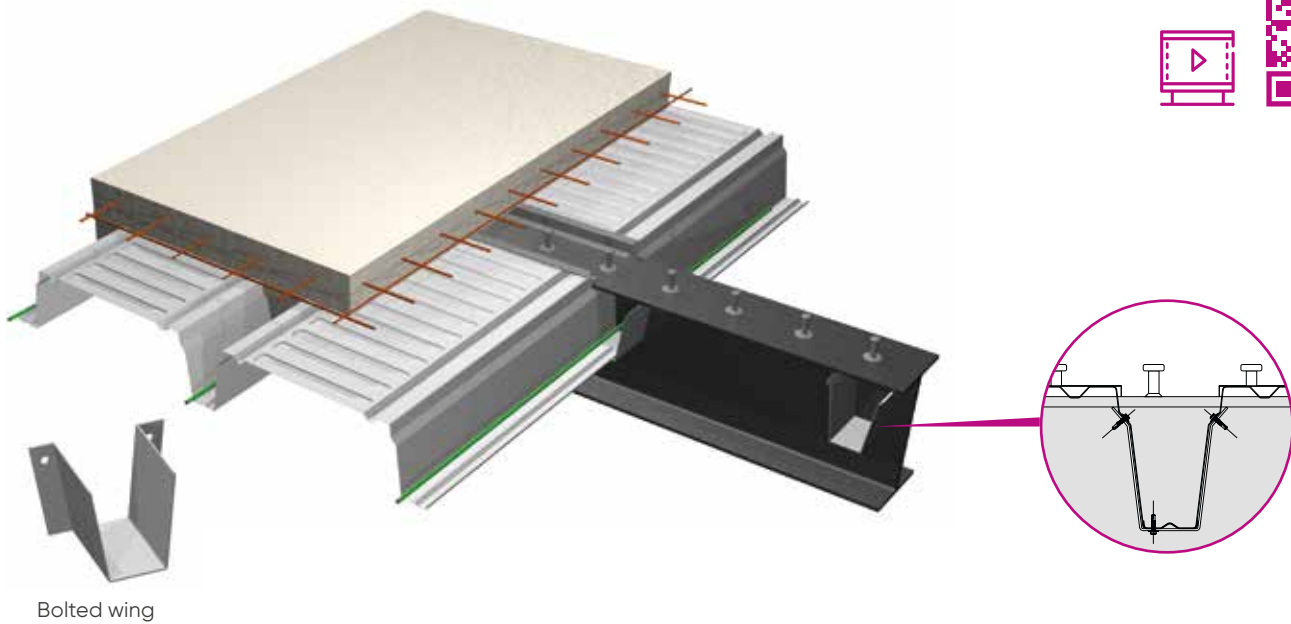

Slim Floor system

The combination of Cofraplus[®] 220 with a CoSFB beam avoids the beam dropping and protects it in case of fire.

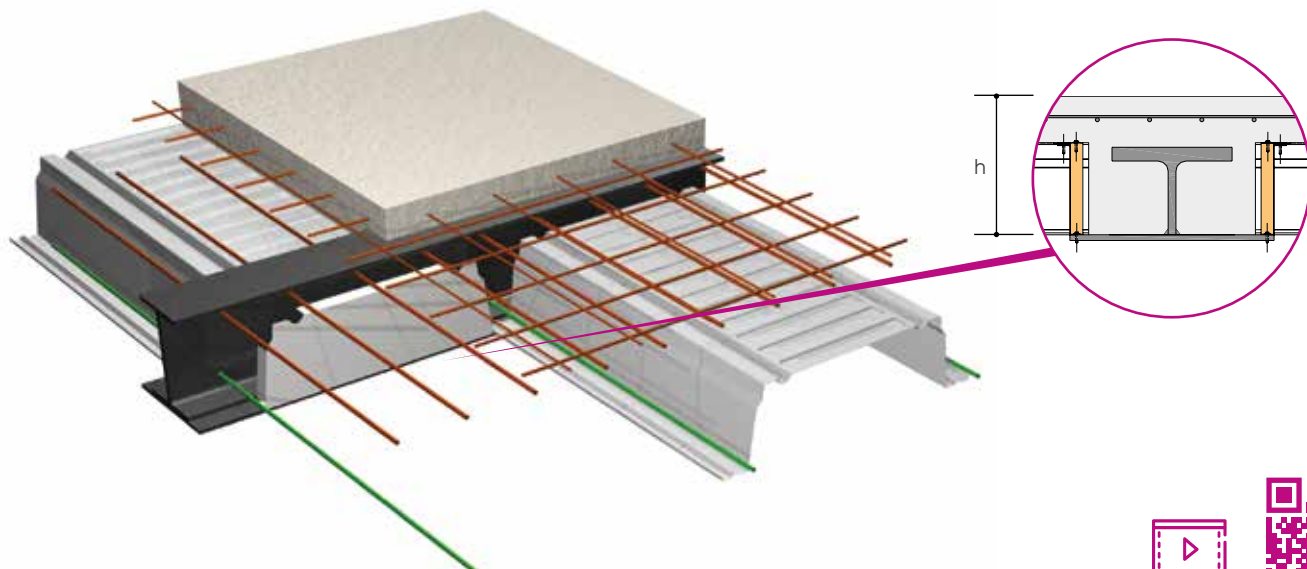

Cofraplus® 220

Installation

Supports

On timber or steel beam

Wings can be either welded in shop to the web of the steel beam or bolted on site requiring holes in the web of the steel beam.

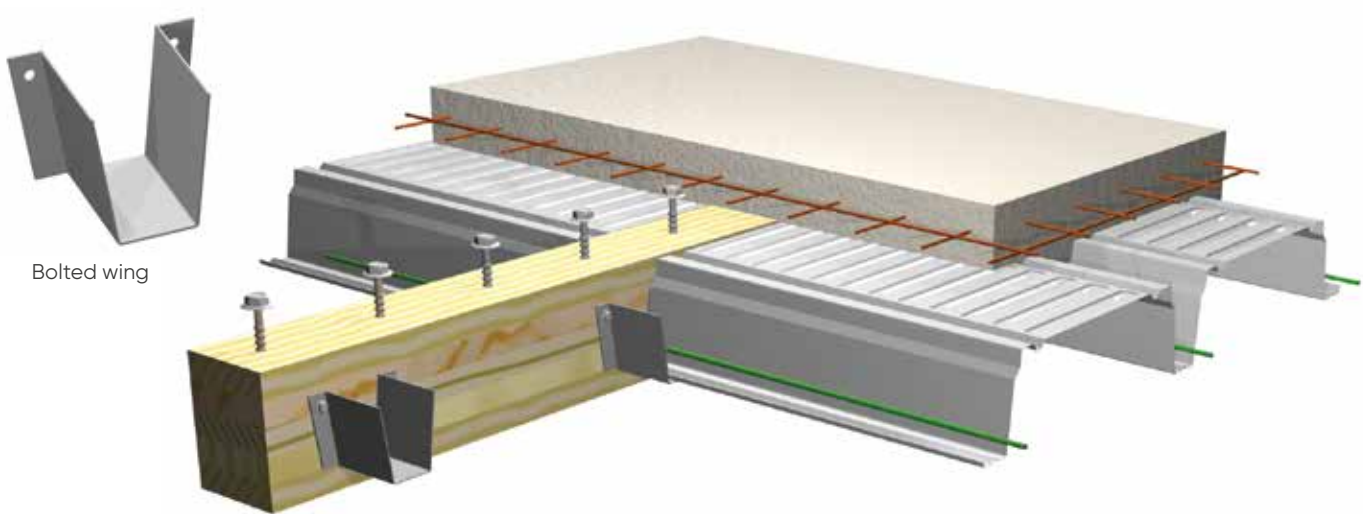

On concrete beams

The end diaphragm can either be fixed to the profile in advance, before it is installed on the supporting structure, or it can be fixed on the support by nailing in order to house the profile.

The brochure "Cofraplus® 220 - installation guidelines" gives more details on the different installation procedures.

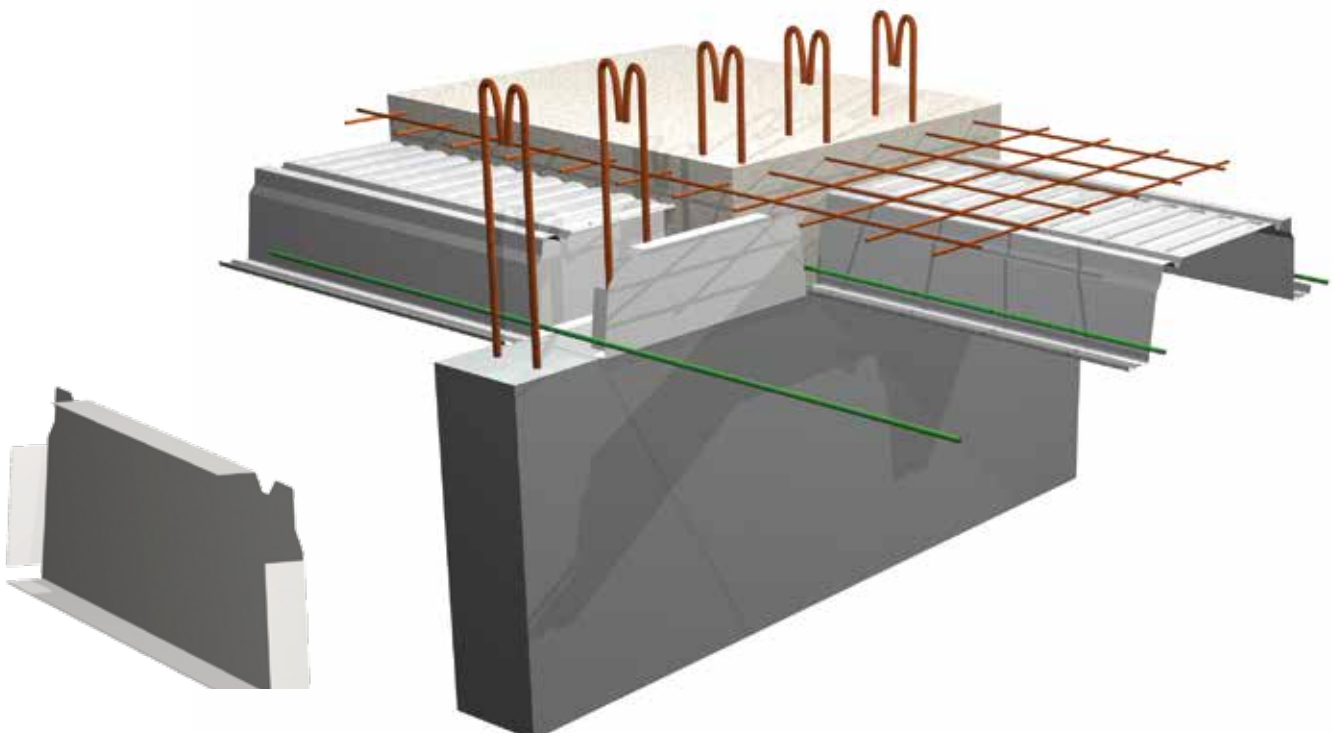

Cofradal® 200 & 260

Integrated composite floor systems

This truly innovative lightweight and insulated floor system is suitable for all types of construction, from commercial buildings to new build multi-story housing and renovation. Using the Slim-Floor solution, Cofradal® allows users to optimise the height and weight of the slab and in turn the building itself. It can be specified in decibel version to provide additional acoustic absorption properties and, when finished with one of ArcelorMittal Construction's organic coatings, it provides an attractive soffit solution.



French technical approval: DTA 3.1/11-687_V2

| Characteristics of the base material | | Norms |
|--------------------------------------|--------------------------------------|--|
| Steel grade | S 320 GD | EN 10346 |
| Type of corrosion protection | ZMevolution® galvanised steel | P 34-310 ETPM ZMevolution® or AbZ Z-30.11-61 |
| | ZM galvanised steel coated evolution | EN 10169+A1 P 34-301 |
| Coating | | |
| Hairplus® 25 | Category CP13 | P 34-310 EN 10169+A1 |
| Other coatings | On demand | |

| Cofradal® | 200 | 260 |
|--|-----|-----|
| Thickness of the complex [mm] | 200 | 260 |
| Weight of the finished floor [kg / m²] Excluding support zones | 240 | 280 |

Fire resistance

| Cofradal® | 200 | | | 260 | | |
|------------------------|-----------------------|---------|---------|---------|---------|---------|
| Span [m] | 5,00 | 6,00 | 7,00 | 6,00 | 7,50 | 8,00 |
| REI [min] | 120 | | | 120 | | |
| G' [kg / m²] | Q [kg / m²] | | | | | |
| 100 | 250 | Ø 12 mm | Ø 16 mm | Ø 16 mm | Ø 16 mm | Ø 16 mm |
| 70 | 350 | Ø 12 mm | Ø 16 mm | / | Ø 16 mm | Ø 16 mm |
| 100 | 500 | Ø 12 mm | / | // | Ø 16 mm | / |

REI: fire protection rating of the net composite slab

The incorporation of a mineral wool insulation and the reinforcement bars permit to obtain a fire resistance rating of REI 120 even for the maximum span.

Two versions

Decibel perforation

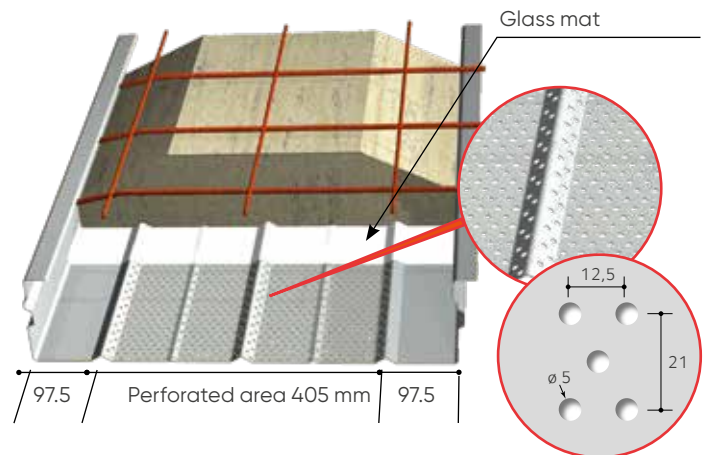

Standard perforation

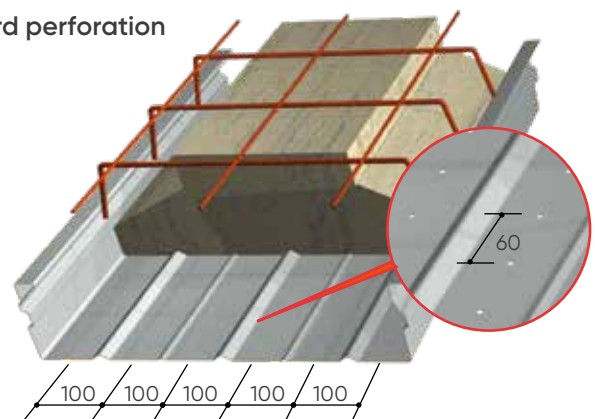

Acoustic performances

Despite its low self-weight, Cofradal® meets the requirements of the acoustic regulations without an additional false ceiling. The "decibel" finish also provides remarkable sound absorption intended to improve comfort of the adjacent rooms below.

| Installation | R_w (C, Ctr) | Ln, w |
|--|-------------------|---------|
| Cofradal® 200 alone(1) | 58 (-1; -6) dB | 78 dB |
| Cofradal® 200 with floating screed (2) Rocksol 501 20 mm + 50 mm screed | 65 (-3; -10) dB | 60 dB |
| Cofradal® 200 decibels - perforated profile (3) | $\alpha_w = 0.85$ | |

(1) Test report CSTB No. AC 04-060 - (2) Test report CSTB No. AC 08-260 13 227 / 2

(3) Test report CSTB No. AC 05-148

Thermal performance

125 mm of mineral wool give the Cofradal® good thermal insulation. Additional insulation material, fixed to the underside, will provide the targeted Up value.

| e [mm] | 0 | 40 | 60 | 80 | 100 |
|-------------------------|------|------|------|------|------|
| Up (W/m ² K) | 0,78 | 0,37 | 0,29 | 0,24 | 0,20 |

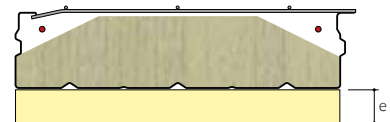

Structural performance

Load / Span table

The value provided in each cell of the table loads is the maximum live load capacity Q (kN/m²), with no safety factor.

The self weight of the slab is already included.

The color of each cell give information about the required steel thickness.

Our engineering design office will be able to refine these values based on the detailed specification of your project

| Cofradal® | Deflection | Span [m] | | | | | | | | | | | |
|--------------|------------|----------|------|------|------|------|------|------|------|------|------|------|--|
| | | 4,00 | 4,20 | 4,40 | 4,60 | 4,80 | 5,00 | 5,20 | 5,40 | 5,60 | 5,80 | 6,00 | |
| 200 standard | 1/350 | 799 | 7,64 | 7,29 | 6,97 | 6,82 | 6,66 | 6,47 | 6,29 | 5,88 | 5,39 | 4,90 | |
| | 1/500 | 6,29 | 6,22 | 6,14 | 6,06 | 5,98 | 5,90 | 5,51 | 5,12 | 4,74 | 4,35 | 3,96 | |
| 200 decibels | 1/350 | 7,14 | 6,99 | 6,85 | 6,57 | 6,43 | 6,27 | 6,02 | 5,67 | 5,23 | 4,79 | 4,35 | |
| | 1/500 | 5,73 | 5,65 | 5,57 | 5,49 | 5,41 | 5,33 | 4,97 | 4,61 | 4,26 | 3,90 | 3,54 | |
| 260 standard | 1/350 | 7,26 | 7,15 | 7,05 | 6,81 | 6,69 | 6,57 | 6,42 | 6,28 | 6,13 | 5,99 | 5,85 | |
| | 1/500 | 7,18 | 6,97 | 6,79 | 6,37 | 6,18 | 5,98 | 5,74 | 5,50 | 5,26 | 5,02 | 4,78 | |

| Cofradal® | Deflection | Span [m] | | | | | | | | | | | |
|--------------|------------|----------|------|------|------|------|------|------|------|------|------|------|--|
| | | 6,20 | 6,40 | 6,60 | 6,80 | 7,00 | 7,20 | 7,40 | 7,50 | 7,60 | 7,80 | 8,00 | |
| 200 standard | 1/350 | 4,56 | 4,22 | 3,88 | 3,54 | 3,20 | | | | | | | |
| | 1/500 | 3,69 | 3,43 | 3,16 | 2,90 | 2,63 | | | | | | | |
| 200 decibels | 1/350 | 4,06 | 3,77 | 3,47 | 3,18 | 2,89 | | | | | | | |
| | 1/500 | 3,31 | 3,08 | 2,86 | 2,63 | 2,40 | | | | | | | |
| 260 standard | 1/350 | 5,55 | 5,25 | 4,96 | 4,66 | 4,37 | 4,21 | 4,07 | 3,99 | 3,92 | 3,77 | 3,63 | |
| | 1/500 | 4,55 | 4,32 | 4,08 | 3,85 | 3,62 | 3,52 | 3,43 | 3,37 | 3,32 | 3,23 | 3,13 | |
| 260 decibels | 1/350 | 4,55 | 4,32 | 4,08 | 3,85 | 3,62 | 3,52 | 3,43 | 3,37 | 3,32 | 3,23 | 3,13 | |
| | 1/500 | 4,55 | 4,32 | 4,08 | 3,85 | 3,62 | 3,52 | 3,43 | 3,37 | 3,32 | 3,23 | 3,13 | |

Consumption of materials

| Cofradal® | Height h [mm] | Concrete volume (l / m ²) |
|-----------|---------------|---------------------------------------|
| 200 | 200 | 100 |
| 260 | 260 | 120 |

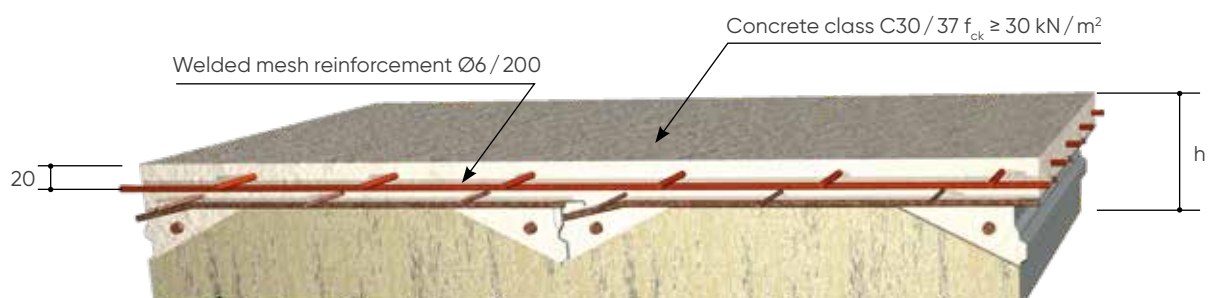

Cofradal[®] 200 & 260

Installation

Stitching

The elements are stitched among each other using self-tapping screws 6.3 x 19 mm in a distance of 1,0 m supplied on site.

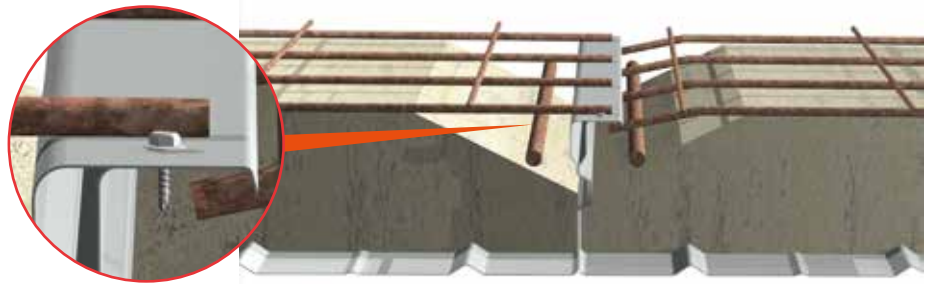

On SFB or CoSFB beam (composite slim floor beam)

Incorporation of the CoSFB beam in the thickness of the Cofradal[®] system avoids any joist and gives a fire resistant rating of R60 without any additional protection measures.

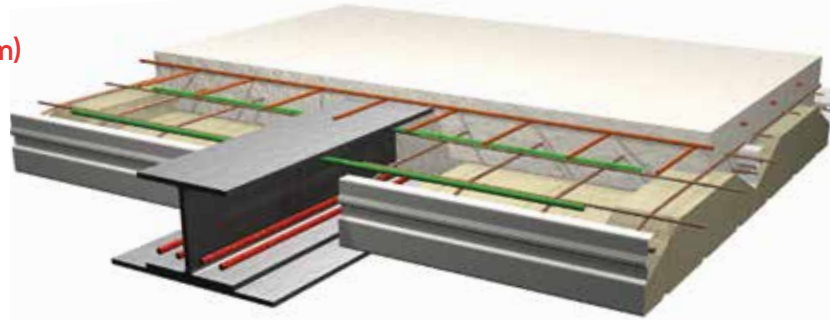

The height of the shear connectors h_s depends on the height of the Cofradal system ($h=200$ or 260 mm)

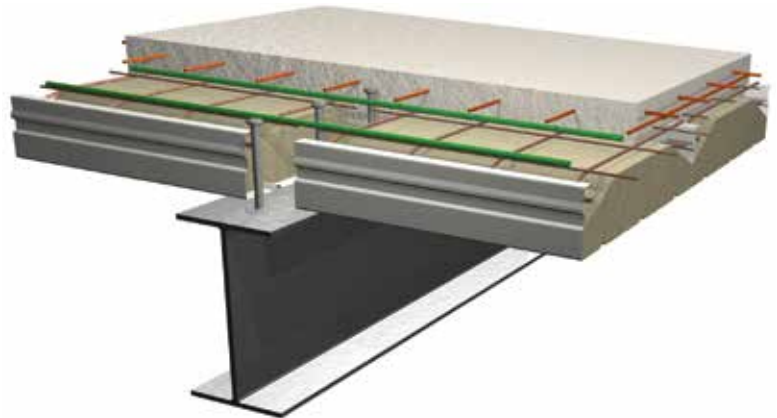
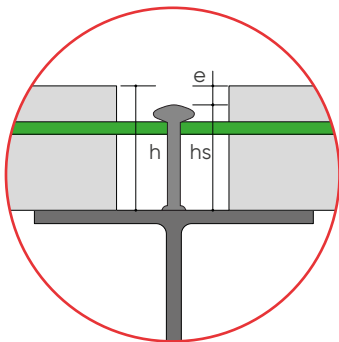

On reinforced concrete or pre-stressed concrete

On support negative moment reinforcement: \varnothing 8 mm minimum ($e=300$ mm) length = $L/3$

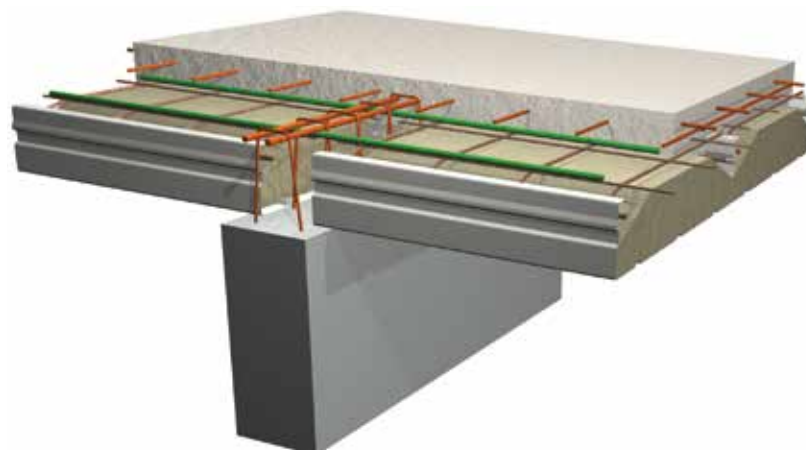

On composite timber beam

In order to transfer the horizontal forces of the floor to the load-bearing frame, it is recommended to fix connectors in the timber beam or timber wall. The connectors are designed inline with the bracing requirements.

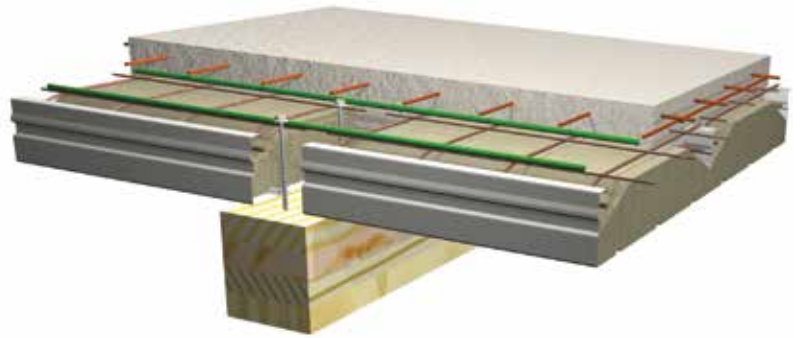

Borders & edges

A layout plan provided for each site will give details of the slab edges. Fixing of edge trims is easy to implement and is adaptable to any type of support.

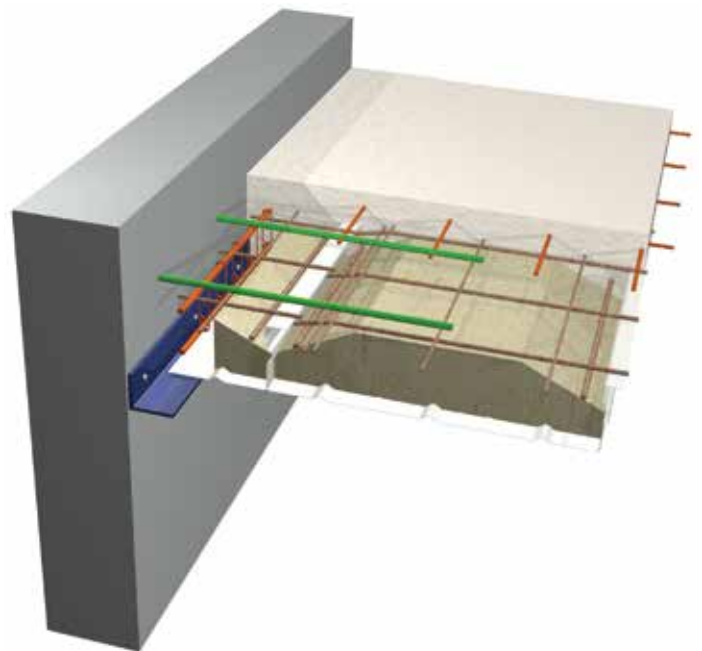

Propping

A shoring plan is provided, as well as an installation plan.

Cofradal® Standard

Without props for span ≤ 3 m according to a study by our engineering design office.

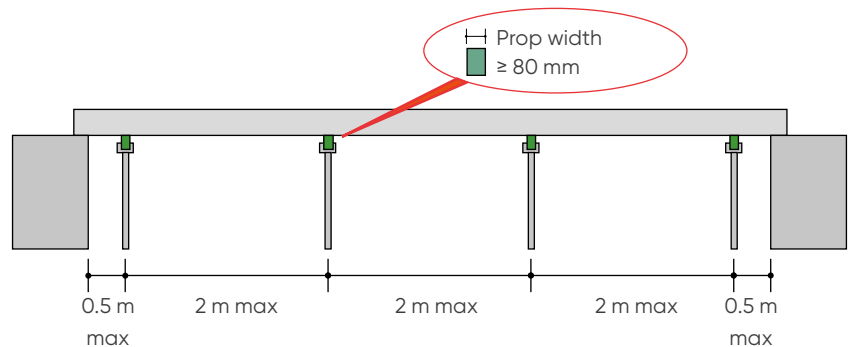

Cofradal® Decibel

In the case of a Decibel finish, particular attention should be paid to the quality and nature of the shoring finishing. Protection against scratches is recommended.

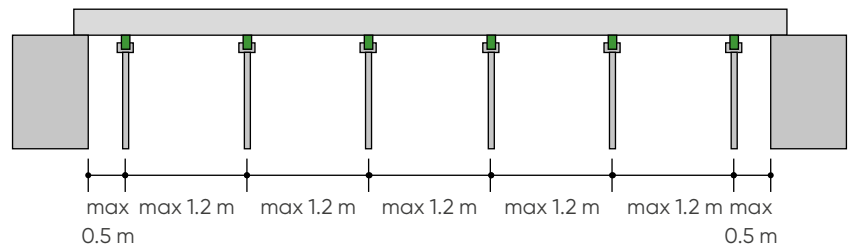

Installation



Installation

Composite floor decking



Cofrastra® 70 with profile filler installed on composite beam with double shear studs



Concrete pouring on Cofraplus® 220 filling first the ribs



Installation of Cofradal® 200

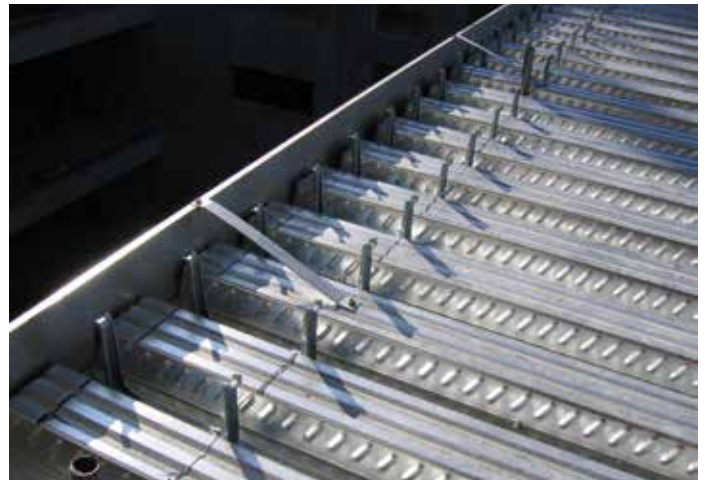

Edge trim with restraint strap and nailed shear studs



Soffit of Cofradal® Decibel



Installation within rehabilitation project - Cofraplus® 60

Installation

Composite floor decking

Support conditions and fastening

Installation on concrete or metal beam

Support width ≥ 50 mm

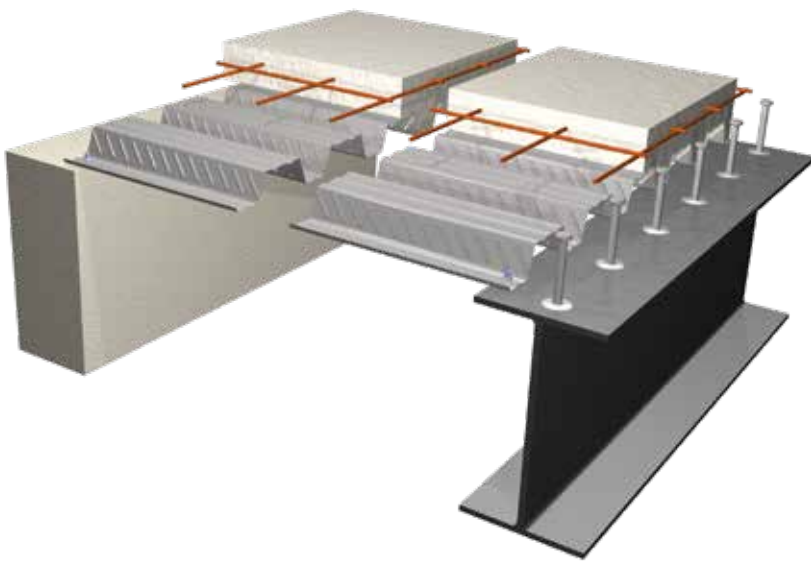

Installation on brick wall or timber structure

Support width ≥ 70 mm

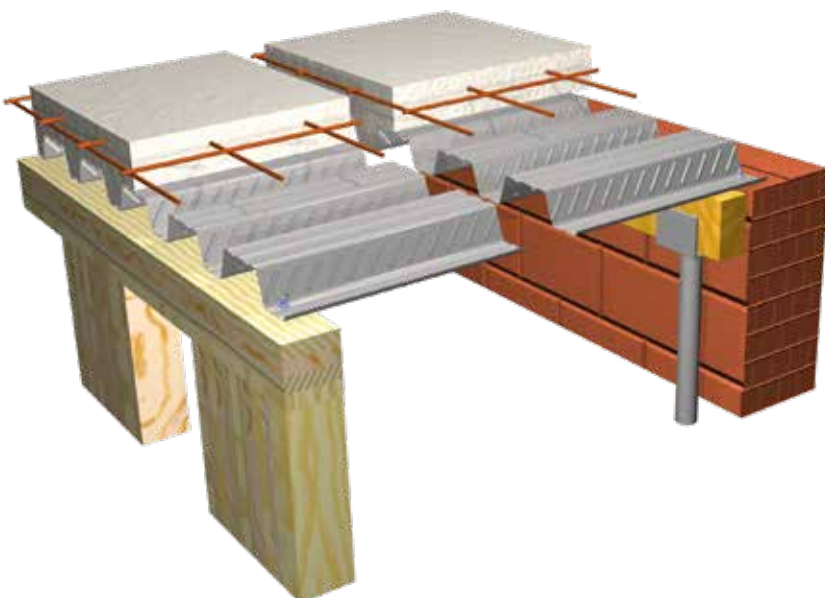

Fastening and stitching

Each profile will be fixed at each end with 2 fasteners per support (except on intermediate supports in case the profile is continuous). The fasteners will be chosen in respect of the type of support.

Fixing on supports

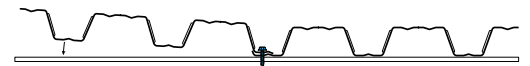

Stitching by rivets or self-taping screws



In the absence of fixing on a support, safety in the temporary phase can be ensured by a sliding rail.

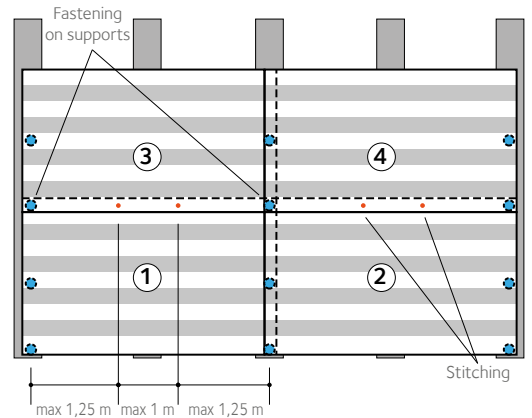

Installation

Composite floor decking

Overview

End diaphragm or appropriate profile filler

The ribs are getting closed at the end of the profile sheet either by appropriate profile filler or metallic diaphragm. The single elements or as running-band types get fixed by tape or by self-tapping screws.

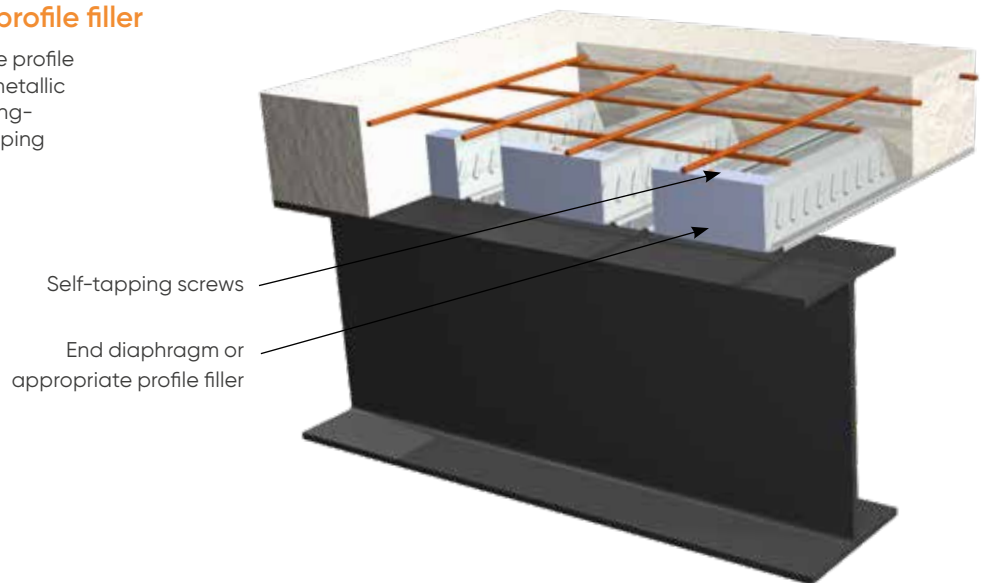

Continuity between two profiles at their top end

In case the profiles can not be overlapped (re-entrant or dovetail shapes), adhesive tape might seal the join between the top end of 2 profiles.



Concrete cover

Applied concrete cover has to follow the indications of the calculation note (according to the exposure and structural class of the structure and / or its fire resistance). The anti-cracking reinforcement mesh respect a concrete cover of at least 20 mm.



Installation

Composite floor decking

End supports

On steel beam

Edge trims serve as vertical formwork for the final slab. Its height is equal to the thickness of the final slab, and it gets fastened to the support.

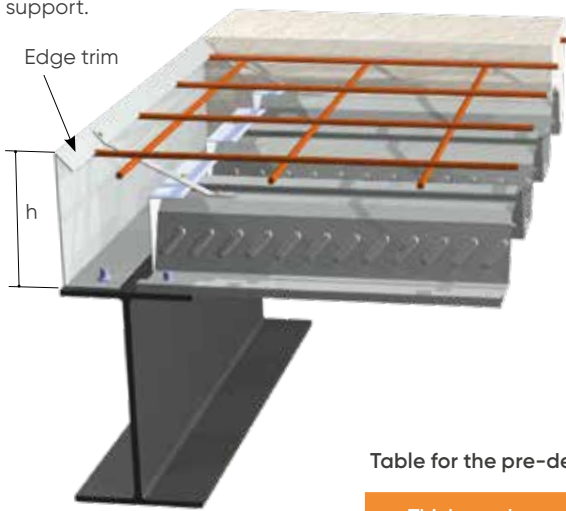

Restraint straps are desirable for floor heights $h > 150$ mm in order to limit the deformation of the edge trim.

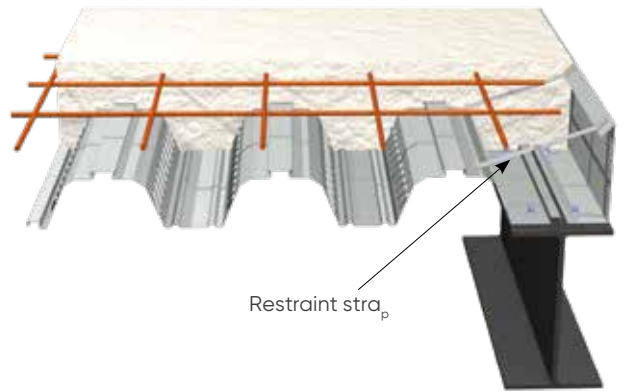
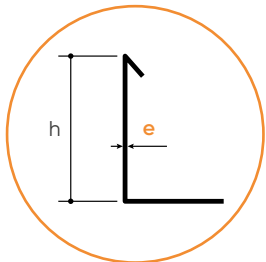

Table for the pre-design and definition of the steel thickness e of the edge trim [mm]

| Thickness h of the slab [cm] | Cantilever f [mm] | | | | | | | | |
|--------------------------------|---------------------|------|------|------|------|------|------|------|------|
| | 0 | 25 | 50 | 75 | 100 | 125 | 150 | 175 | 200 |
| 9 | 0,88 | 0,88 | 1,00 | 1,00 | 1,20 | 1,20 | 1,50 | 2,00 | 2,50 |
| 10 | 0,88 | 0,88 | 1,00 | 1,00 | 1,20 | 1,20 | 1,50 | 2,00 | 2,50 |
| 11 | 0,88 | 0,88 | 1,00 | 1,20 | 1,20 | 1,50 | 1,50 | 2,00 | 2,50 |
| 12 | 0,88 | 0,88 | 1,00 | 1,20 | 1,50 | 1,50 | 2,00 | 2,00 | 2,50 |
| 13 | 0,88 | 1,00 | 1,20 | 1,50 | 1,50 | 2,00 | 2,00 | 2,50 | 2,50 |
| 14 | 1,00 | 1,20 | 1,20 | 1,50 | 1,50 | 2,00 | 2,00 | 2,50 | 2,50 |
| 15 | 1,20 | 1,20 | 1,50 | 1,50 | 2,00 | 2,00 | 2,50 | 2,50 | 2,50 |
| 16 | 1,20 | 1,50 | 1,50 | 2,00 | 2,00 | 2,50 | 2,50 | 2,50 | 2,50 |
| 17 | 1,20 | 1,50 | 1,50 | 2,00 | 2,00 | 2,50 | 2,50 | 2,50 | 2,50 |
| 18 | 1,50 | 1,50 | 2,00 | 2,00 | 2,50 | 2,50 | 2,50 | 2,50 | 3,00 |
| 19 | 1,50 | 1,50 | 2,00 | 2,00 | 2,50 | 2,50 | 2,50 | 2,50 | 3,00 |
| 20 | 2,00 | 2,00 | 2,50 | 2,50 | 2,50 | 3,00 | 3,00 | 3,00 | 3,00 |

Edge trim



e : nominal thickness of galvanised metal for the edge trim [mm]

On composite beams with shear studs

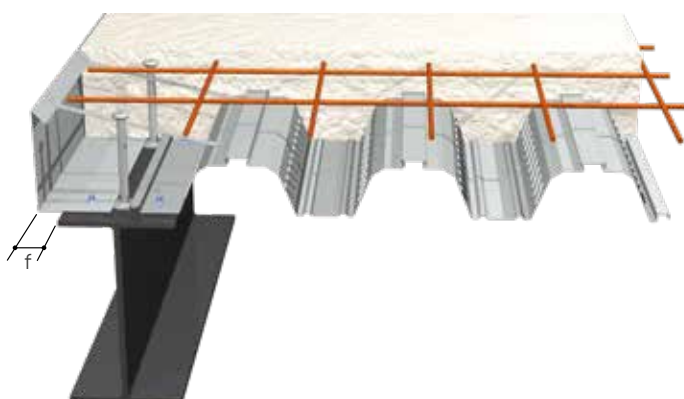

f : cantilever

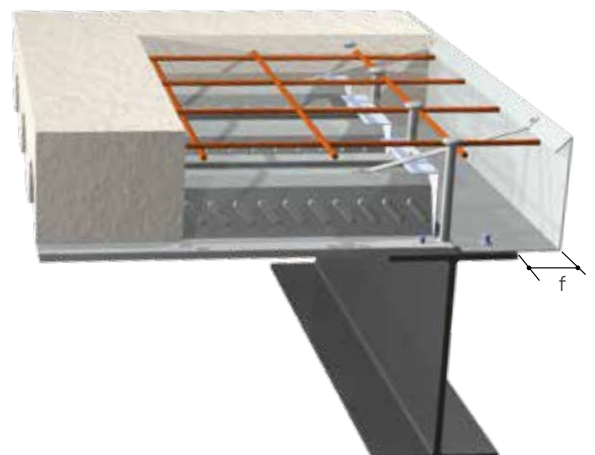

Installation

Composite floor decking

End supports

On concrete

The slab can be anchored by additional reinforcement bars, as traditionally used in reinforced concrete structures.

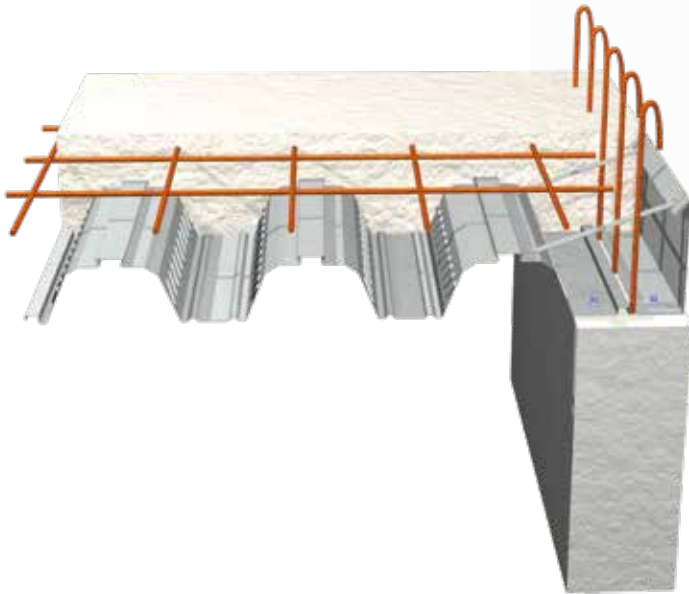
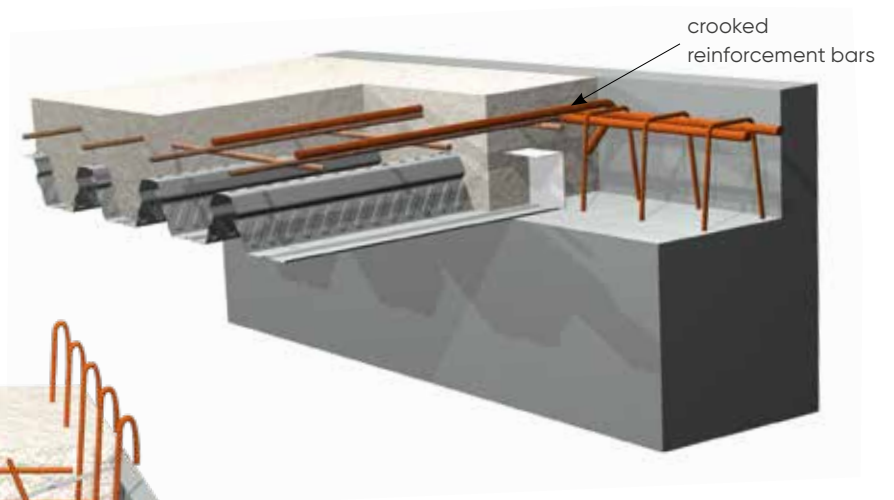

A layout plan should optimise the situation at the end supports.

Free edge

The free sides of the slab should receive a longitudinal stiffener.



Installation

Composite floor decking

End supports

On existing masonry

The steel angle must be pinned into the reinforced concrete pockets made beforehand in the existing wall. The number of pins and their cross-section are to be defined by the supplier of the angle pieces.

Linear engraving



On running-band angle piece



On masonry

Side wall chaining will be produced in accordance with the Eurocodes, in line with potential seismic requirements



Installation

Composite floor decking

Mid-supports

On concrete wall

The pinning of the steel angle will be consistent with the nature of the prop and the loading assumptions.
This calculation is the responsibility of the project engineer or responsible design office.

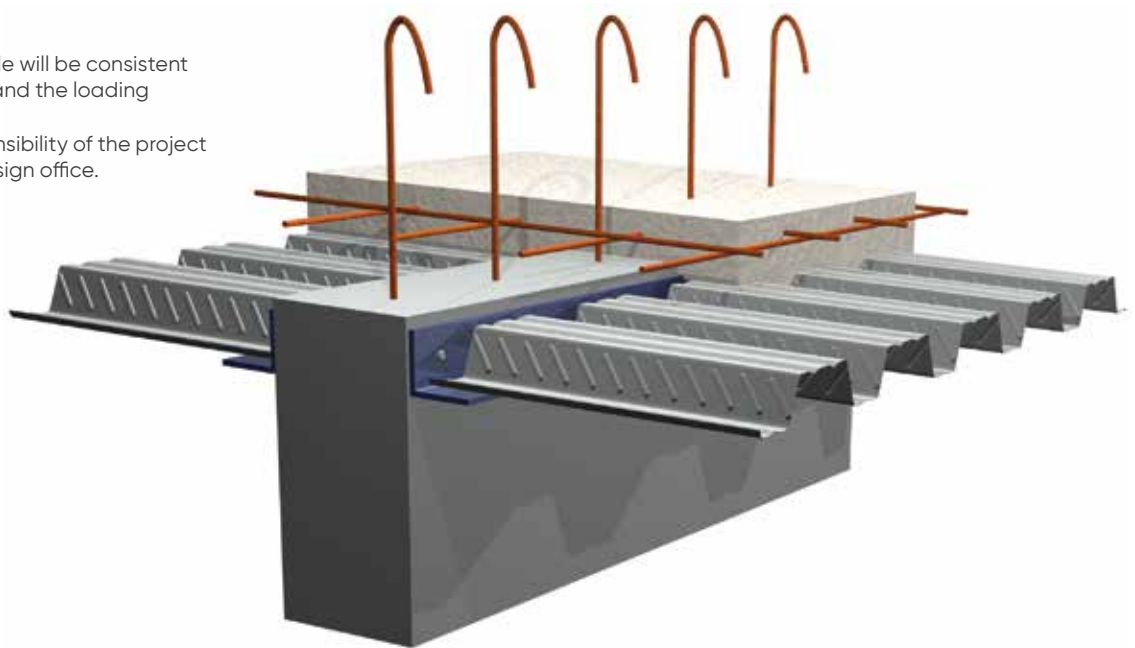

On composite steel beam with shear studs

The ribs of the floor decking can be perpendicular or parallel to the composite beams.
The pre-punching of the profiles gets done in the factory during the profiling process as per instructions on the form which will be given during the order.

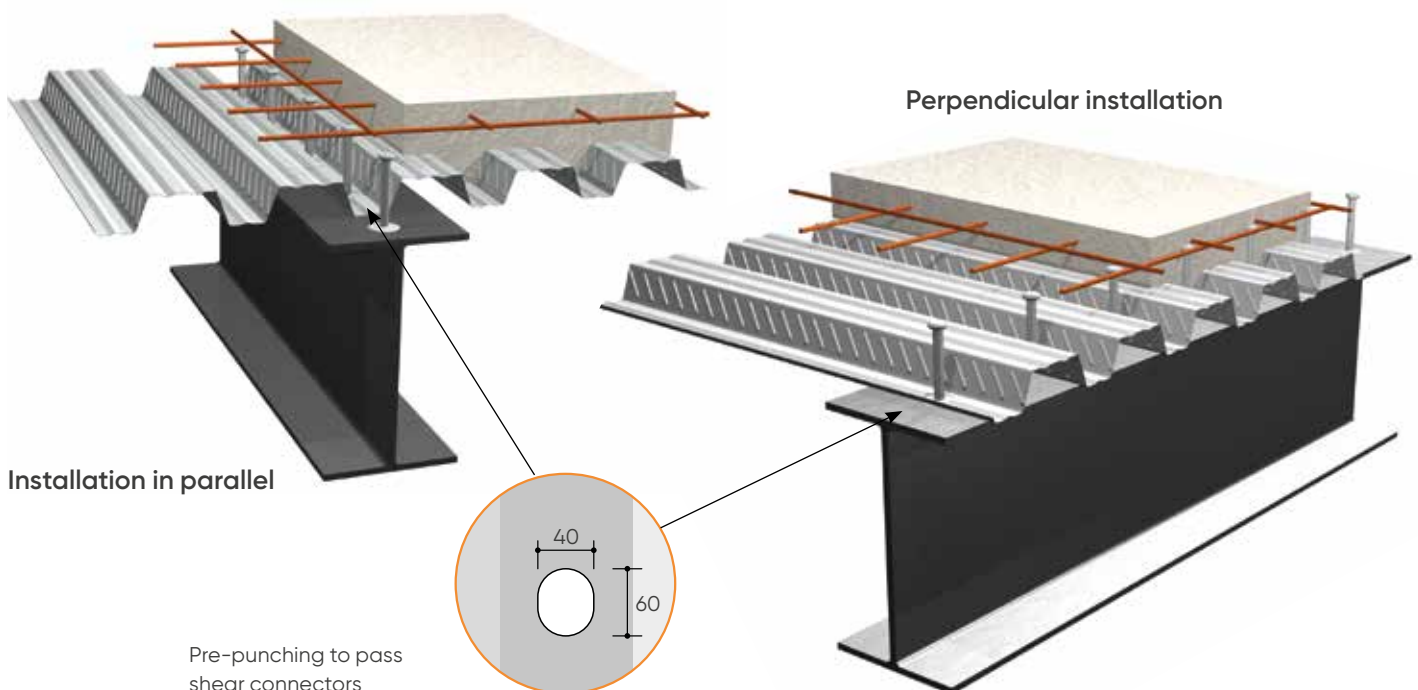

Installation

Composite floor decking

Openings & block-outs

For openings or box out < 500 x 500 mm

The entire profile will be installed across the planned opening. Further, a box-out with a best matching negative geometry of the profile sheet gets installed at the place of the opening to keep away any fresh concrete. After the concrete has hardened, the box out will be removed and the the profile will be cut on request. Additional reinforcement bars get positioned in the thickness of the slab (mini 4 x Ø 10mm).

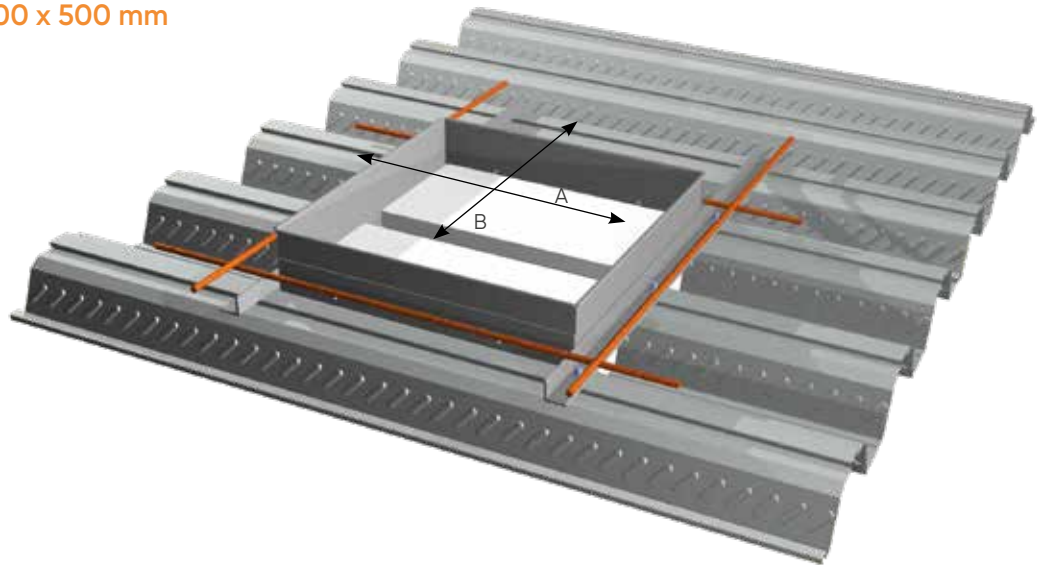

For openings or box out > 500 x 500 mm

A replacing stringer around the opening must either be incorporated in the thickness of the slab (reinforced concrete calculation to be done by the project engineer), or a secondary frame must be installed below the slab.

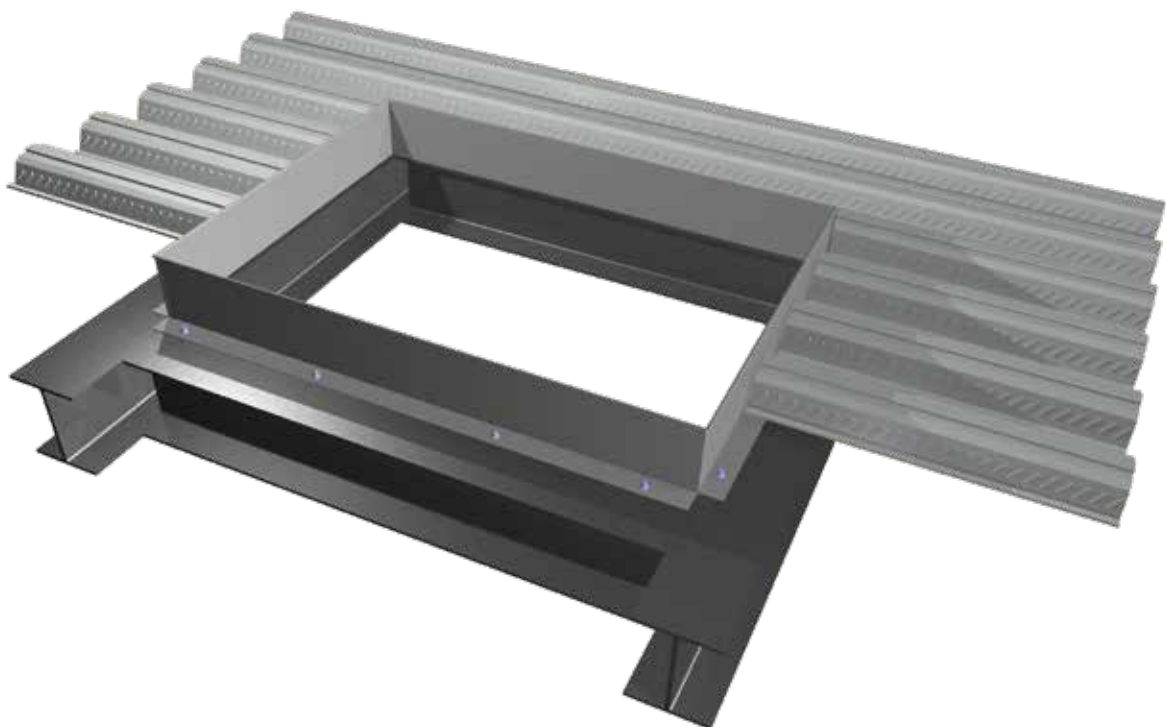

Installation

Reinforcement

Installation recommendations for additional reinforcement

Orientation

The direction of the largest diameters of the welded mesh is always the direction of the effective span .

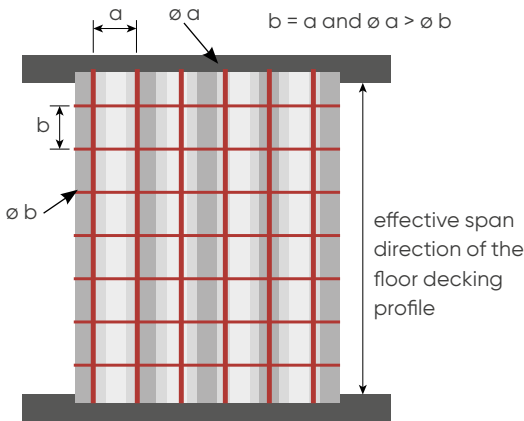

If the mesh consists of bars of the same diameter but different distances between 2 wires, the wire mesh must be positioned so that - per metre run - the greatest number of diameters is in the direction of the effective span of the floor decking.

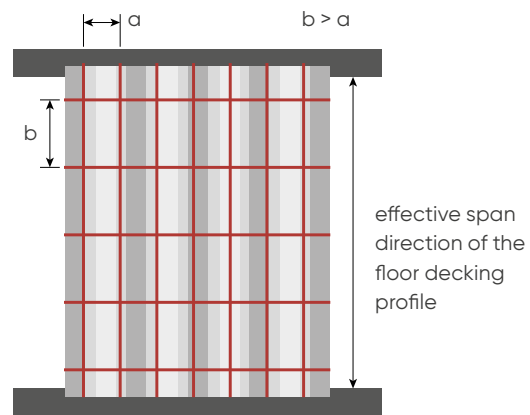

In order to provide the necessary concrete cover, only 3 layers of reinforcement meshes should be installed. It is therefore important to respect the following recommendations:

Minimum concrete cover

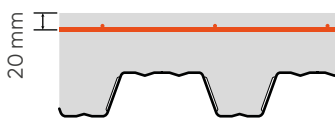

Overlaps and lapped joints of reinforcement meshes

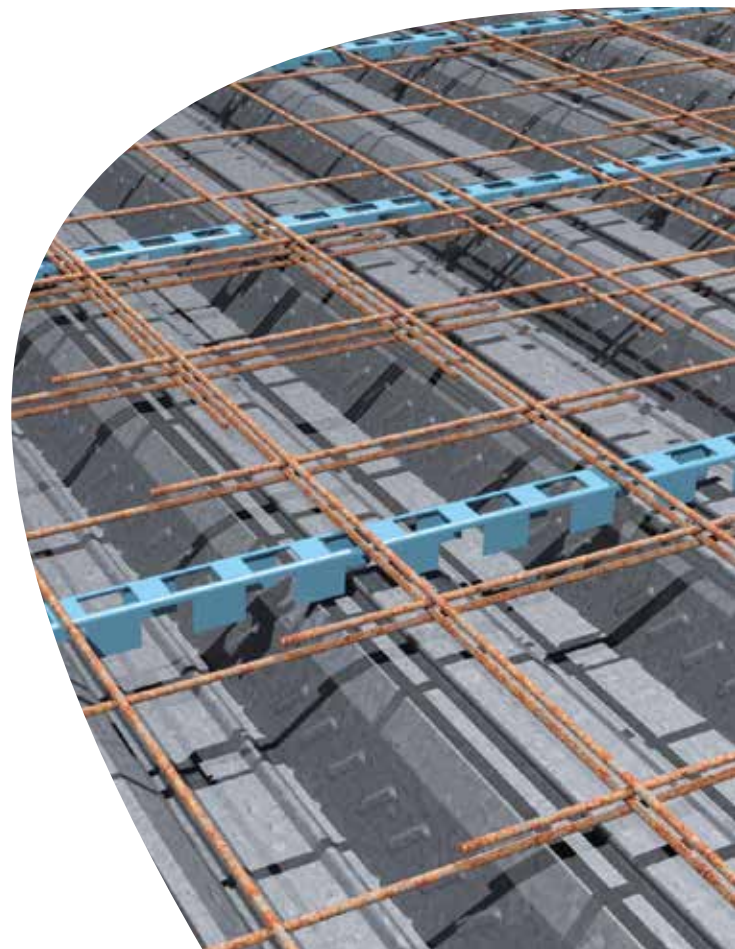
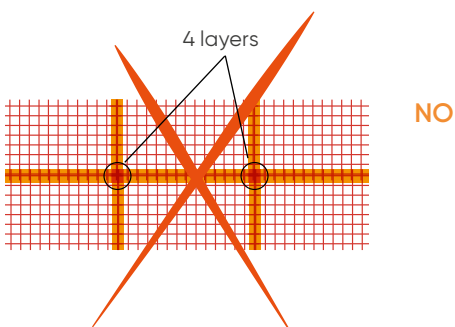
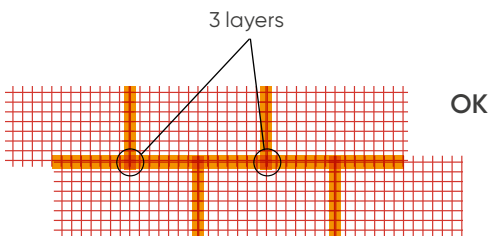

General safety instructions



1 ■ Check usage & conditions of the PPE



2 ■ Use adequate slings and lifting tools to unload bundles



3 ■ Ensure individual safety



4 ■ Ensure collective safety



5 ■ Nail profiles in accordance with the installation progress

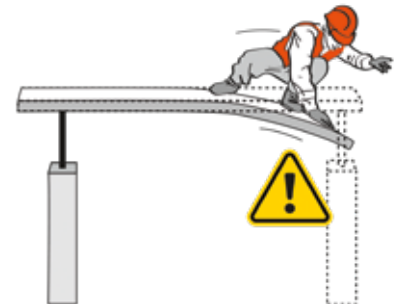

6 ■ Prop where cantilevers are larger than 200mm



7 ■ Survey concrete thicknesses using a pin rather than a laser level which is not considering deflection of the main structures



8 ■ Install fall protection for openings and block-outs



9 ■ Use a suitable prop equipment



10 ■ Store profile bundles with a slight slope to avoid accumulation of rainwater



11 ■ Handle profile sheets correctly

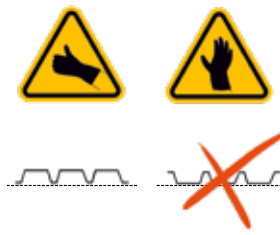

12 ■ Comply with correct orientation of the profile sheet

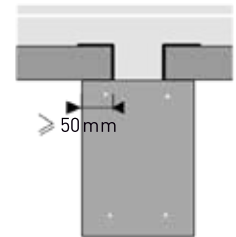

13 ■ Comply with minimum supports widths

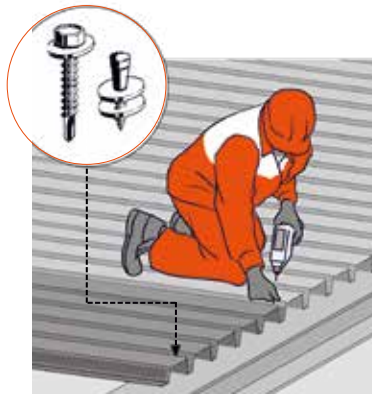

14 ■ Fix profiles sheets on supports and stitch them among each other (2 fixings per profile sheet and per end support)

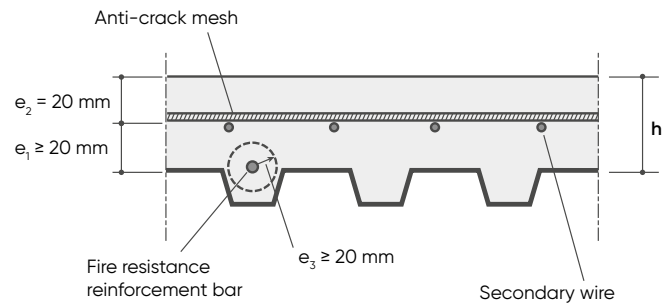

15 ■ Place the welded reinforcement mesh in the right position
 16 ■ Comply with required concrete using adequate spacers for mesh and rebar reinforcement



17 ■ In case of propping, use a classical formwork beams instead of single props

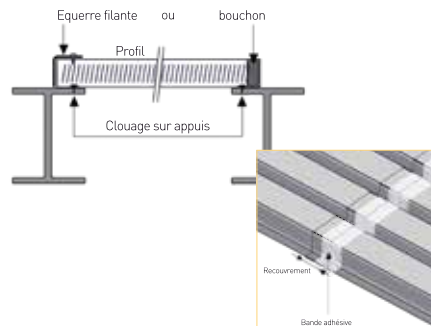

18 ■ Ensure sealing & tightness at the end supports and on the overlaps



19 ■ Avoid any concrete accumulation while concreting

ArcelorMittal Construction



Smarter steels for
people and planet

[construction.arcelormittal.com](https://www.construction.arcelormittal.com)

This publication is not a contractual document. Due to a policy of continual product development, ArcelorMittal Construction reserves the right to alter any of the specifications given in this publication without prior notice. No responsibility for accuracy is accepted by ArcelorMittal Construction. All information contained in this brochure is the sole property of our company and any unauthorized use is strictly forbidden.